

Commercial vehicle accessories and spare part plant



**АГАТ СПЕЦКОМПЛЕКТ**

***Made in Russia***





**АГАТСПЕЦКОМПЛЕКТ**

**Made in Russia**



## About Company

The plant of automotive components "Agatspeckomplekt" is a supplier of automotive parts and components for commercial vehicles among the leading automakers and bodybuilders of Russia. More than 300 employees work at the industrial complex of the company in Kstovo. The total manufacturing area of the company is more than 12 000 sq. m. About 250 items of hardware are brought into operation, allowing to master the widest spectrum of technological experience in the area of the metalworking and industrial assembly.

Our company is a supplier of the following market leaders in Russia: Gaz Group, Knorr-Bremse, Luidor, Politrans, Avtomash, Promavto, Tonar factory, Grunwald, Manak-Avto, CentrTransTechMash, Ruscomtrans, AMZ and more than 100 other manufacturers of special machinery on the territory of the Russian Federation. The production of the enterprise is exported to 8 foreign countries.







The company is focusing on the producing of the following automotive components:

- Folding pillars for drop-side trucks and curtainsiders designed on the base of the original locking mechanism. Our company offers curtainside and dropside pillars along with dropside locks for aluminum board trucks.
- The locking gears for trucks' and semitrailers' doorways. They are produced zink coated and of stainless steel. It should be noted that all metal products of our company are galvanic coated with a protective varnish Silver that adds to the products a specific silver shade and the highest anticorrosive feature.
- Body and functional truck elements (rear ladder, protection bar, mudguard's clamp, fastening bracket, perforated sheet, recessed swing).
- The braking systems (brake master and wheel cylinder) and the gear levers are produced for the conveyer of GAZ Group and brand stores of spare parts.
- Aluminum and iron parts of automotive components (the parts of the compressor) are supplied to Knorr-Bremse.







**ARAT SNEUKOMPLEKT**

**Made in Russia**

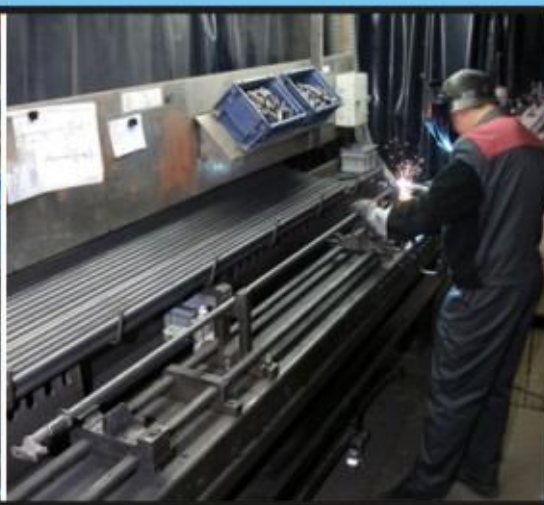

The activity of our enterprise is regulated by requirements ISO 9001 2011 and quality requirements of our custom companies. By coworking with the GAZ Group and Yomo-Consulting company our enterprise consistently implements Toyota production system for several years (the Kanban system, flow building and standardized work) and the other modern methods of production management (PPAP, FMEA, statistical process control and analysis). The reliability of manufactured products is daily subjected to a critical test in different usage conditions, such as: reagent influence in the cities, exploitation at extremely low temperature in the northern regions of Russia and, finally, good practice of product application in such hot countries as: Chile, Costa Rica, Egypt and Kazakhstan.

**The most important advantages of the company are:**

- Competitive prices, caused by the process of full technological and production management and longtime relations with the suppliers of materials
- The provision of trade credit
- The possibility of item reworking due to requirements of a certain customer that is provided by the availability of own tool production and more than 20 years' experience in producing of stamps and molds.







## F Van accessories

### F0 Hinges

- F01 Hinge (Zn, SS) – 6306034-09
- F02 Hinge (Zn, SS) – 6306034-07
- F03 Hinge (Zn, SS) – 6306034-08
- F04 Hinge (Zn, SS) – 6306034-12
- F05 Hinge 01 (Zn, SS) – 6306034-13
- F06 Hinge (Zn, SS) – 6306034-10
- F07 Hinge (Zn, SS) – 6306034-11

### F10 External lock sets

- F11 Push lock set (Zn, SS)
- F12 Delta lock set (Zn, SS)
- F13 Lock set (Zn, SS)
- F14 Lock set (Zn, SS)

### F20 Levers

- F21 PUSH lever kit (Zn, SS) – ГРКП456395.006
- F22 Delta lever kit (Zn, SS) – 6306038-01
- F23 Lever kit (Zn, SS) – 6305414-03
- F24 Lever kit (Zn, SS) – ГРКП45634.021

### F30 Tube clamp

- F31 Tube clamp kit d22 (Zn, SS)
- F32 Tube clamp kit d22 (Zn, SS)
- F33 Tube clamp kit d22 (Zn, SS)
- F34 Tube clamp kit d27 (Zn, SS)
- F35 Tube clamp kit d27 (Zn, SS)

### F40 Cams and keepers

- F41 Small Cam and keeper for lock d22 (Zn, SS)
- F42 Universal kit d22, d27 (Zn, SS)
- F43 Big cam and keeper for lock d27 (Zn, SS)

## A Accessories

### A50 Door retainers

- A51 T-shaped door retainer – ГРКП456399.001ГЧ
- A52 Rear door retainer – ФД01.000
- A53 Rear door retainer – ФД02.000

### A60 Clamps

- A61 Mudguard's clamp – ГРКП301568.003
- A62 Fastening bracket – ГРКП745312.005
- A63 Small fastening bracket – ГРКП745312.005

### A70 Protection bar

- A71 Protection bar – ГРКП455421.001.
- A72 Protection bar with additional fixation – ГРКП455421.002

### A80 Ladders and steps

- A81 Rear ladder with folding steps
- A82 Rear ladder with narrow steps
- A83 Simple ladder
- A84 Sliding 2 step rear ladder
- A85 Sliding 1 step rear ladder
- A86 Step

## L Rigging accessories

- L91 Lashing rail
- L92 Recessed swing – ГРКП 301629.001
- L93 Perforated sheet

## P Pillars

### P100 Folding dropside pillars

- P101 Two-locked intermediate pillar
- P102 One-locked front pillar (left/right)
- P103 Two-locked rear pillar (left/right)

### P110 Folding dropside curtainside pillars

- P111 Folding curtainside pillar series 400
- P112 Folding curtainside pillar series 600
- P113 Folding curtainside pillar series 600 with elongated channel and pockets

### P120 Intermediate dropside pillars

- P121 Intermediate dropside pillar for aluminum boards 86 mm width
- P122 Intermediate dropside pillar for aluminum boards 120 mm width
- P123 Intermediate curtainside pillar for aluminum boards 86 mm width
- P124 Intermediate curtainside pillar for aluminum boards 120 mm width
- P125 Intermediate curtainside pillar for aluminum boards 86 mm width with elongated channel and pockets
- P126 Intermediate curtainside pillar for aluminum boards 120 mm width with elongated channel and pockets

### P130 Intermediate curtainside pillars

- P131 Intermediate curtainside pillar for semitrailer with pockets and telescopic extender
- P132 Intermediate curtainside pillar for semitrailer with pockets and additional slots for swivel

### P140 Dropside locks and spring bolts

- P141 Aluminum non-plug lock (left/right)
- P142 Aluminum plug lock (left/right)
- P143 Corner aluminum lock (left/right)
- P144 Sideboard hinges
- P145 Spring bolt
- P145 Spring bolt



## F Van accessories

### F0 Hinges

F01 Hinge (Zn, SS) – 6306034-09

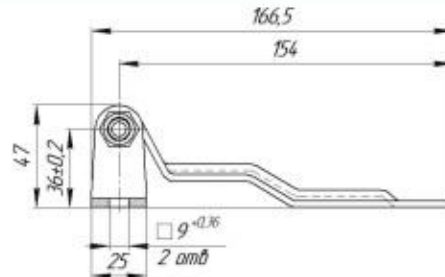

F02 Hinge (Zn, SS) – 6306034-07

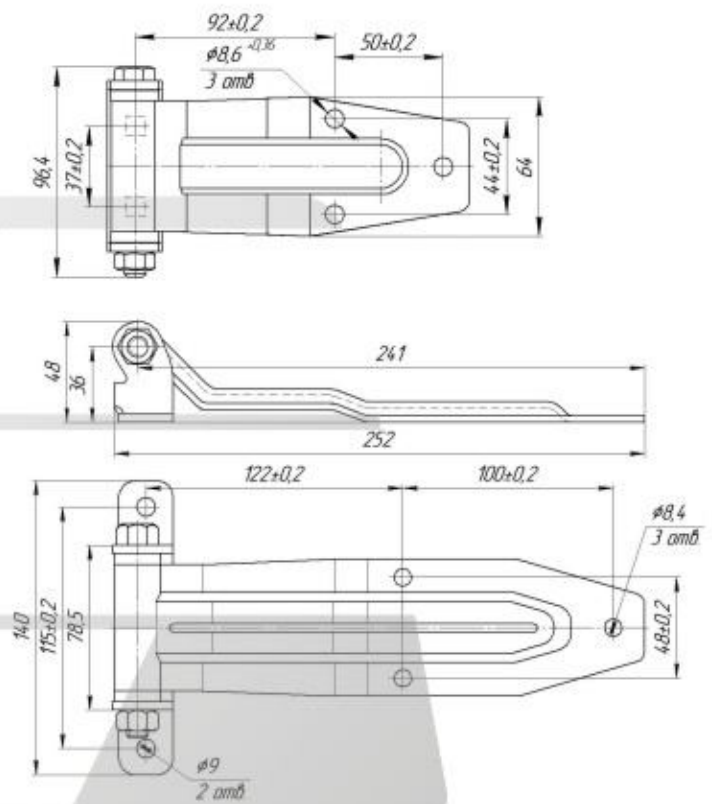

F03 Hinge (Zn, SS) – 6306034-08

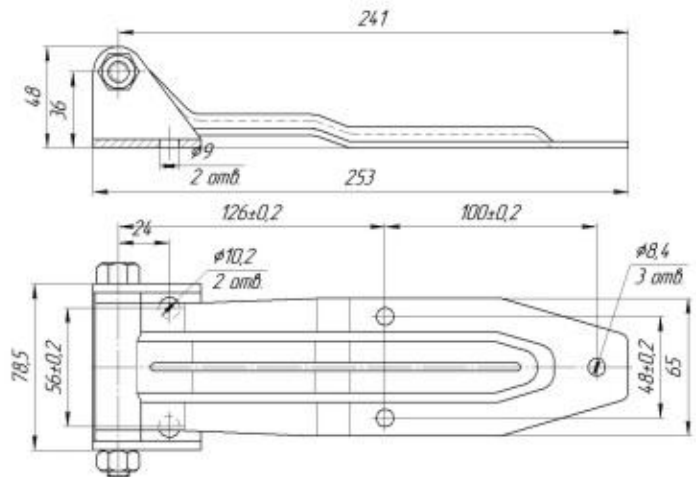



F04 Hinge (Zn, SS) – 6306034-11

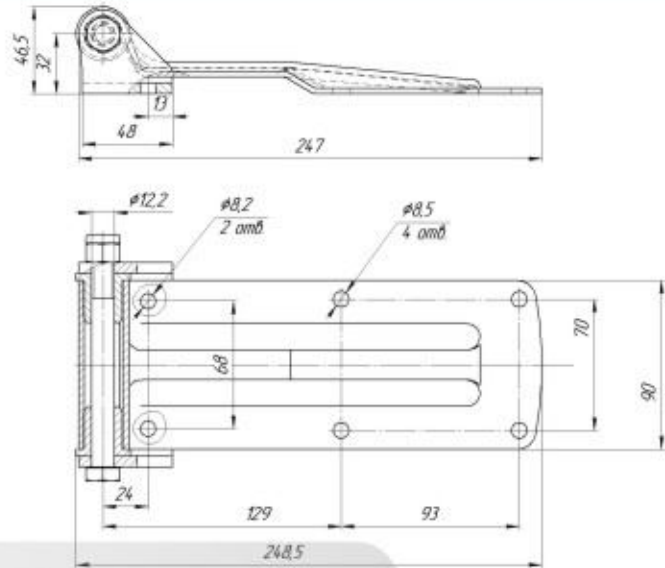

F05 Hinge (Zn, SS) – 6306034-12

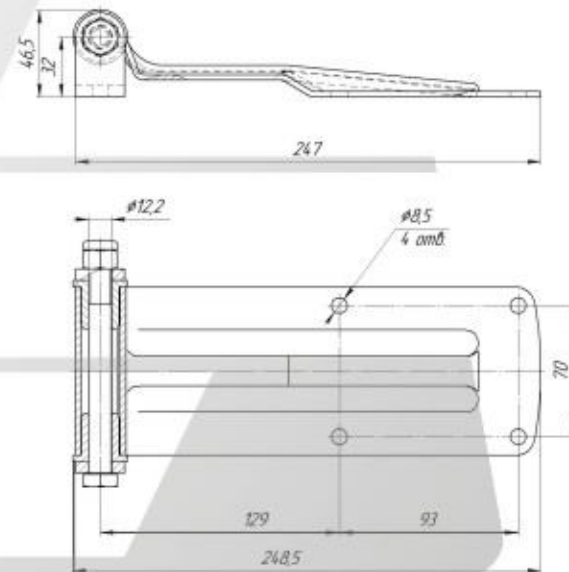

F06 Hinge (Zn, SS) – 6306034-13

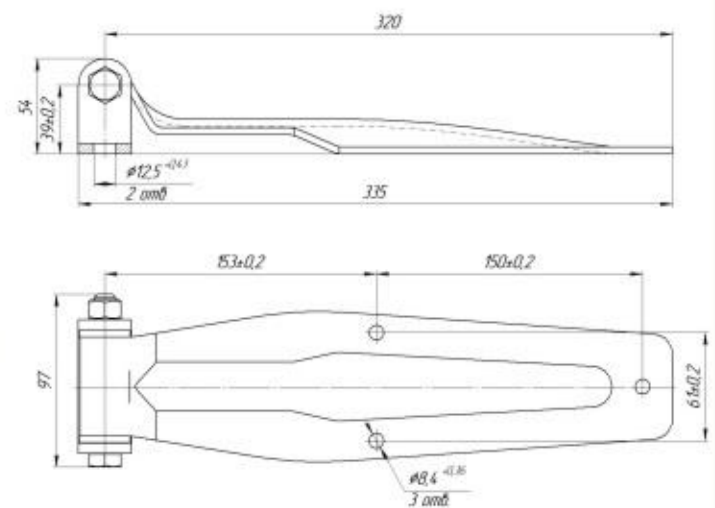





## F10 External lock sets

F11 Push lock set (Zn, SS)

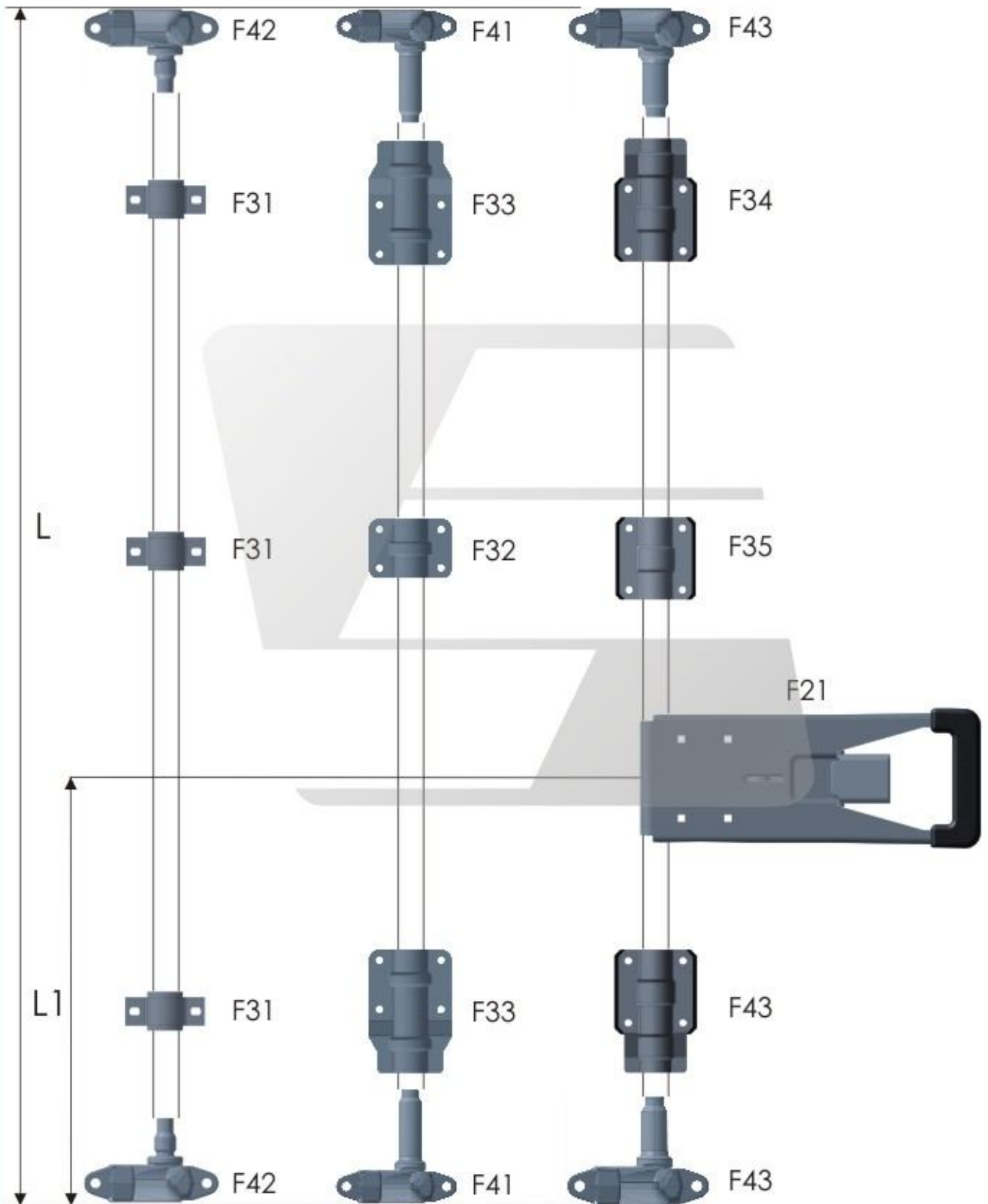





F12 Delta lock set (Zn, SS)

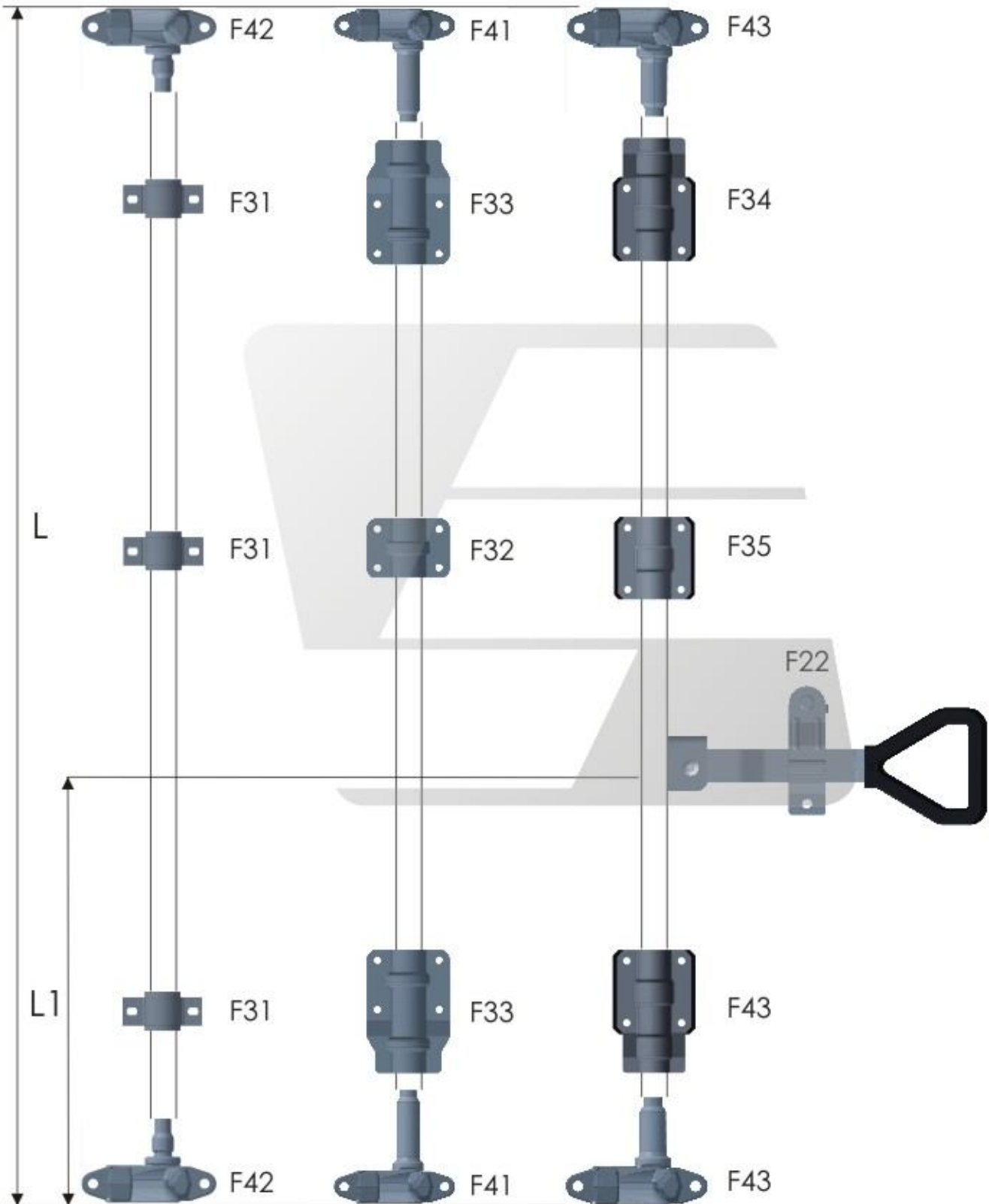



F13 Lock set (Zn, SS)

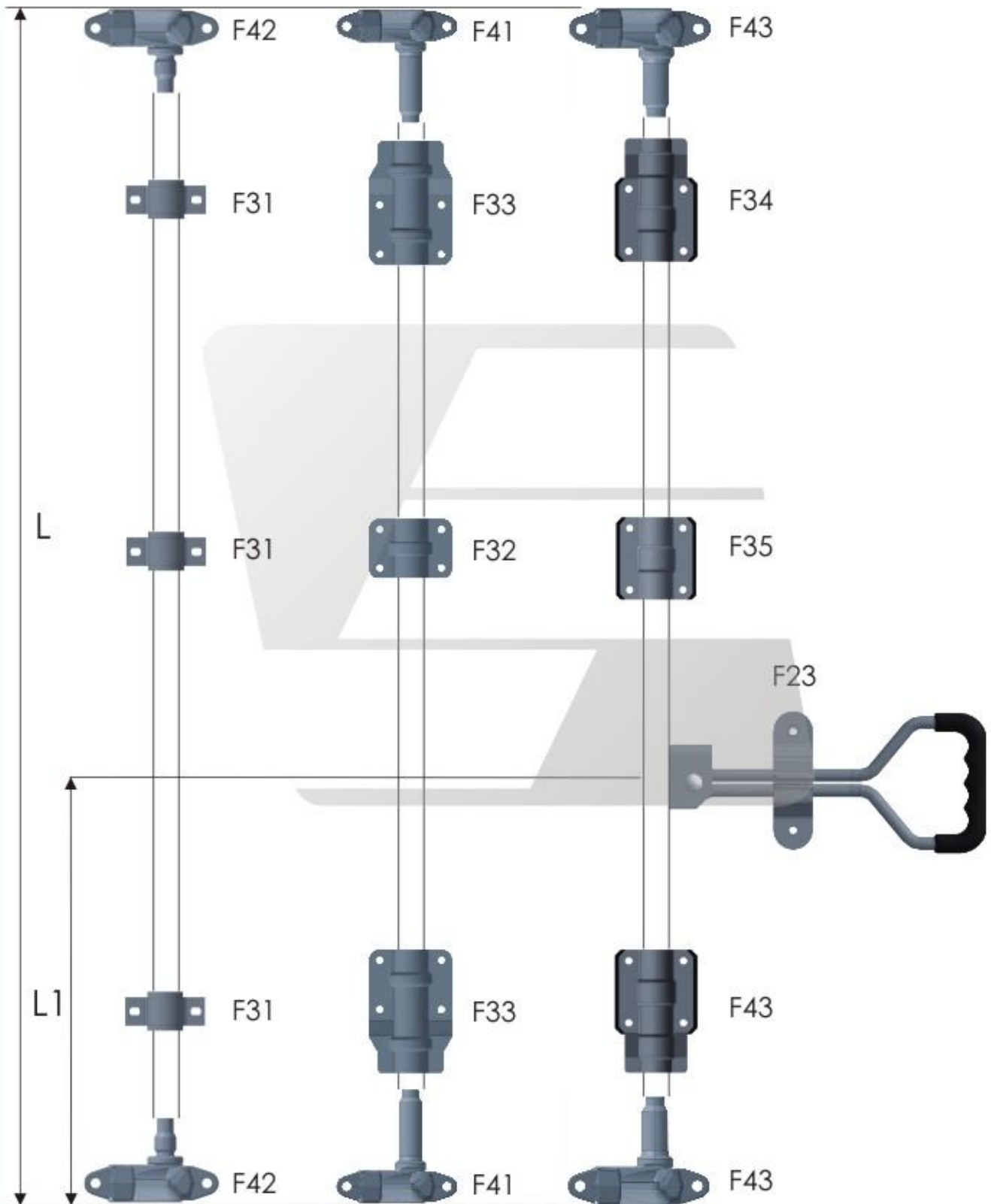





F14 Lock set (Zn, SS)

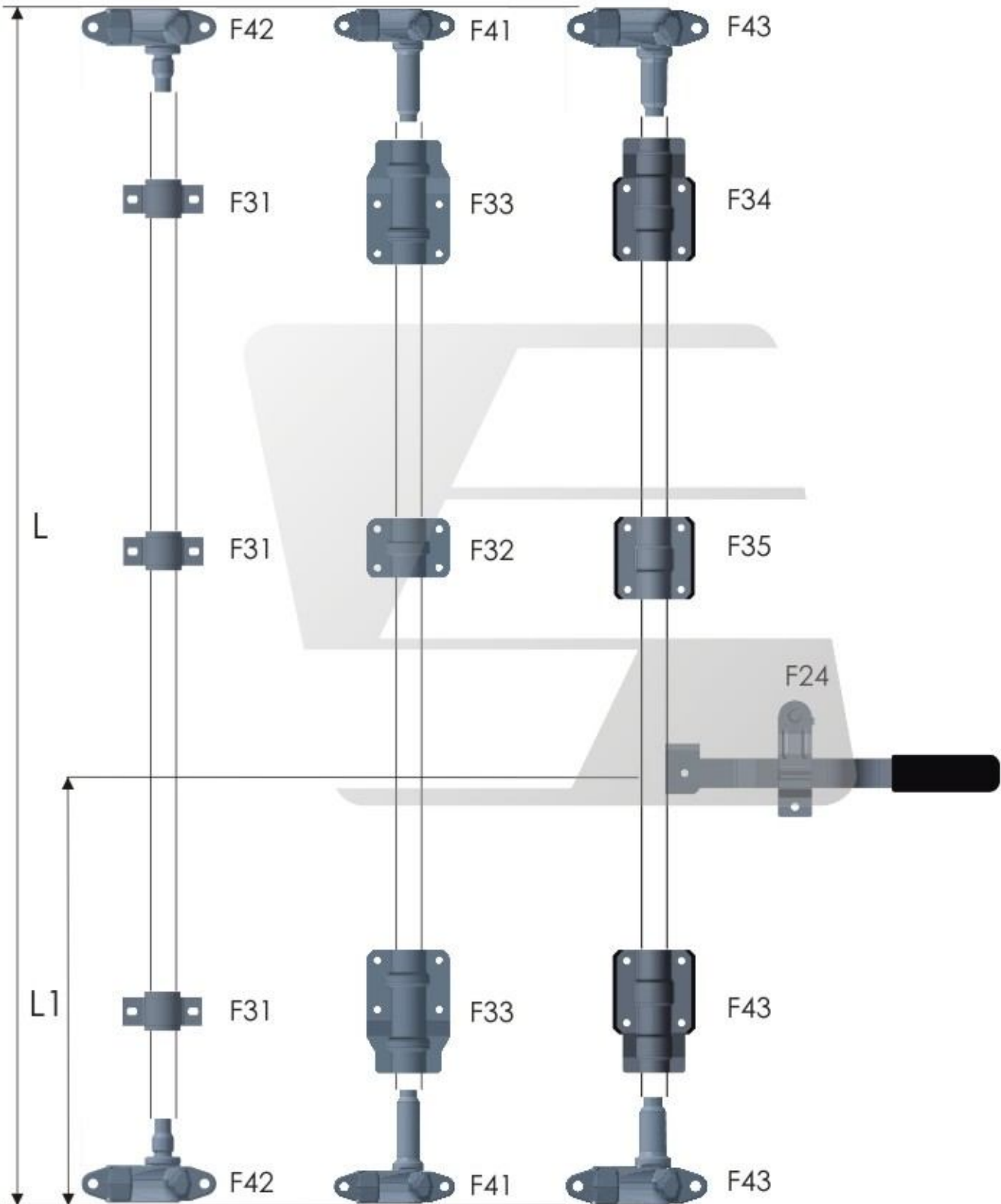



## F20 Levers

F21 PUSH lever kit (Zn, SS) – ГРКП456395.006

Additional characteristics: engraving

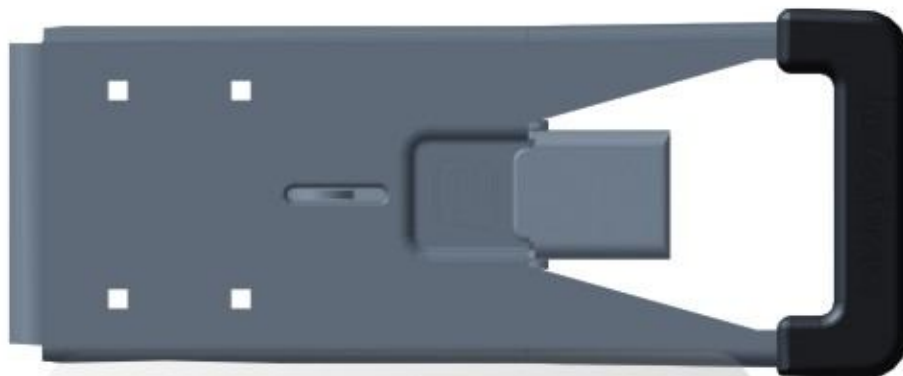

PUSH lever ГРКП 456395.006



Lever mount ГРКП456395.004



Plate ГРКП745242.002

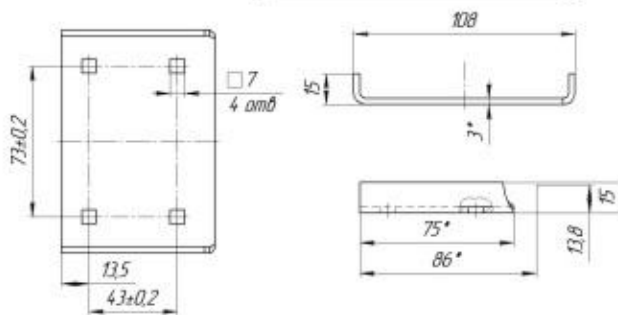
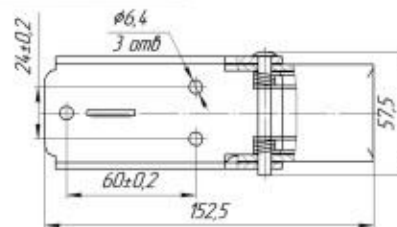
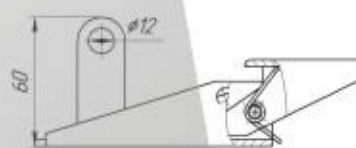
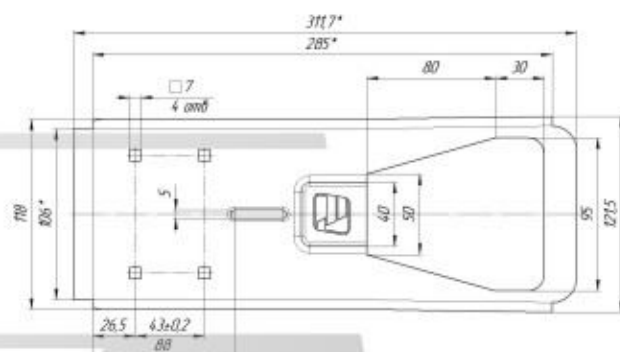





F22 Delta lever kit (Zn, SS) – 6306038-01

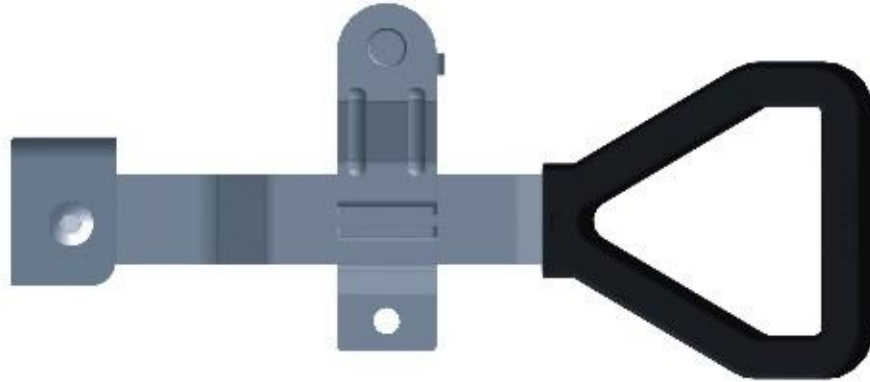

Delta lever 6306038

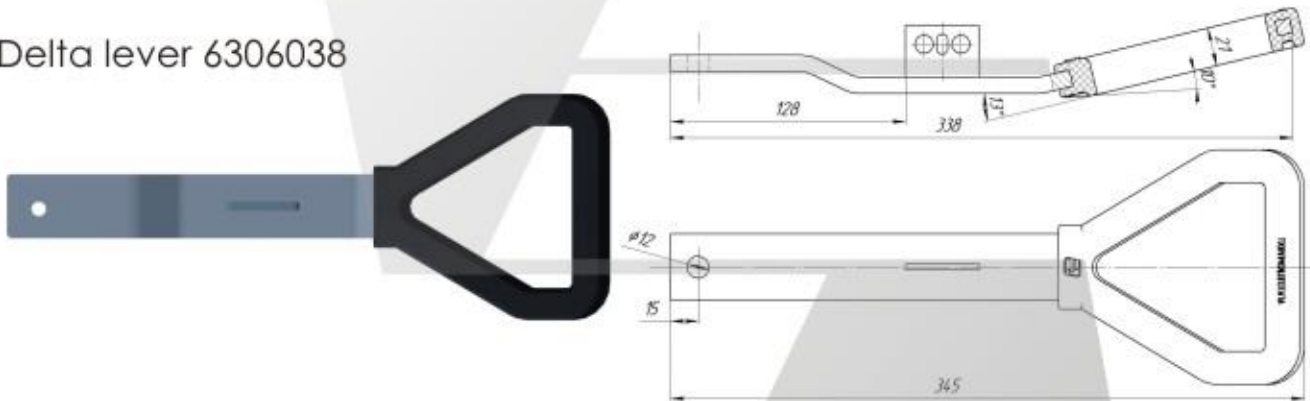

Lever retainer 6306037

Lever mount 6306038.002

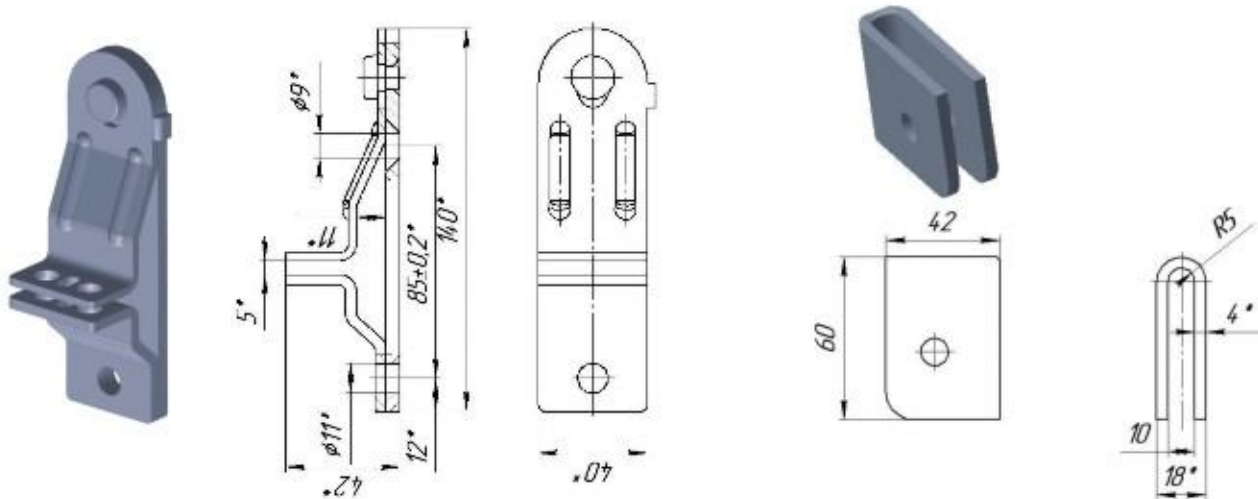



F23 Lever kit (Zn, SS) – 6305414-03



Lever 6305414-03

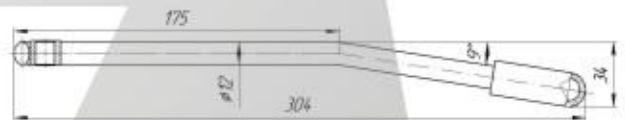
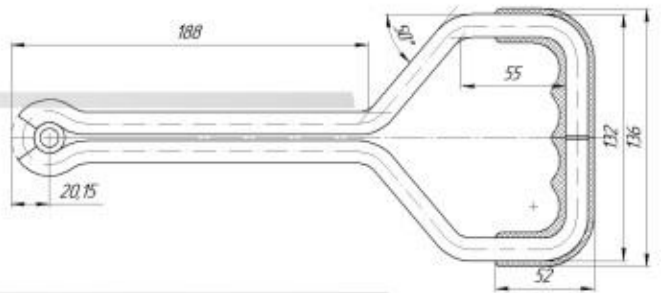

Lever retainer 6305416-03

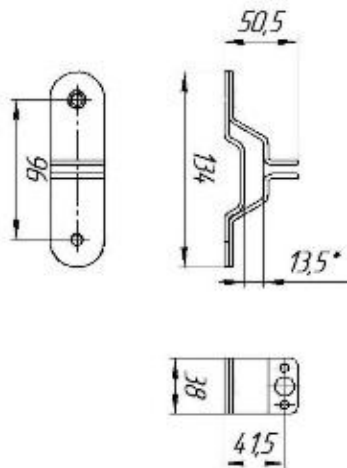

Lever mount 6305412-02

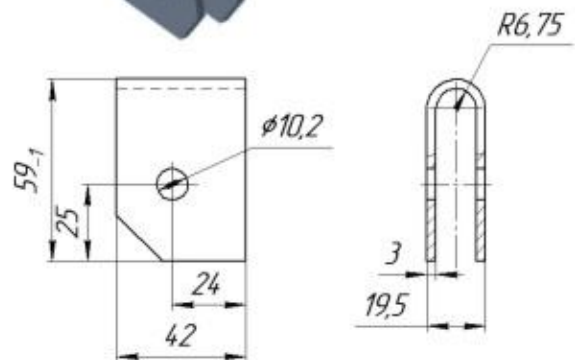





F24 Lever kit (Zn, SS) – ГРКП45634.021

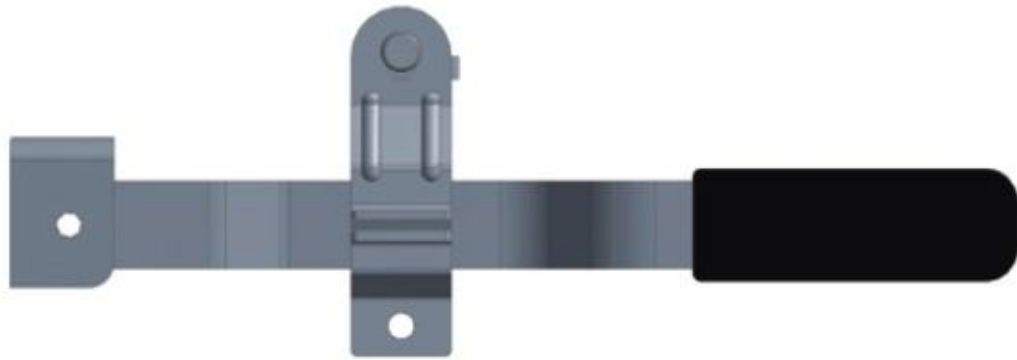

Lever ГРКП303658.004

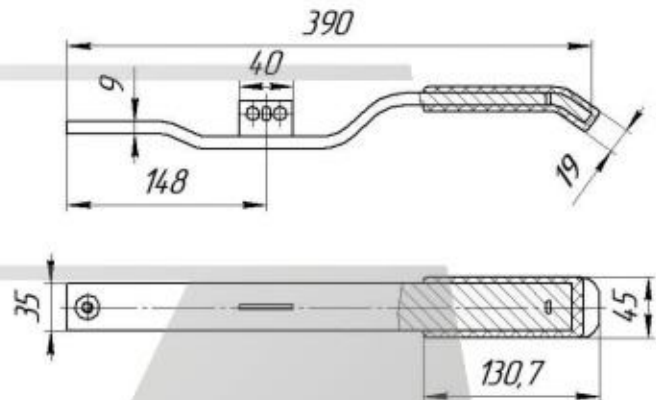

Lever retainer 6306037

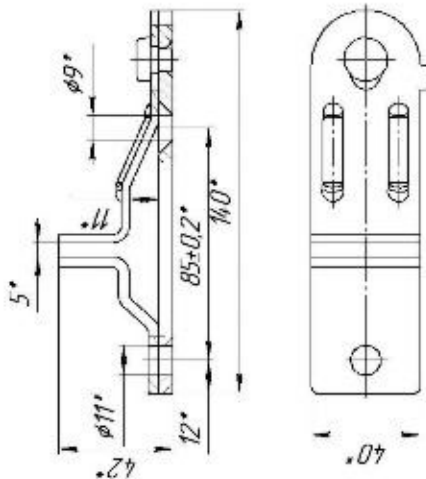

Lever mount 6306038.002

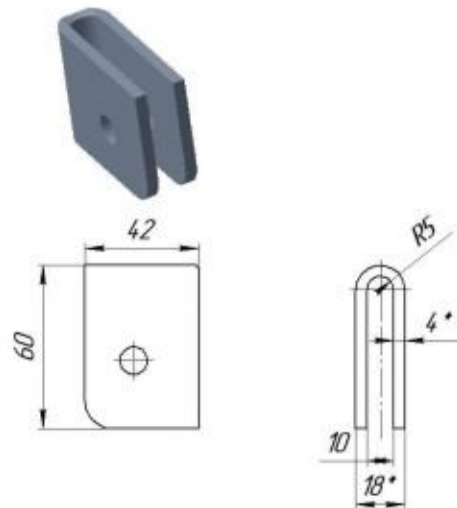



## F30 Опоры

F31 Tube clamp kit d22 (Zn, SS)



Tube clamp (upper) – 6305430-01



Tube clamp plate (lower) – 6305429-01



Bushing – 6305428-01

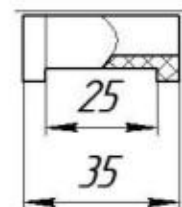
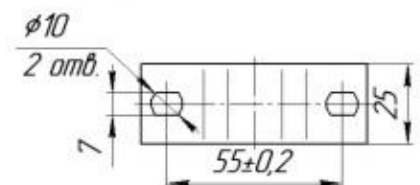
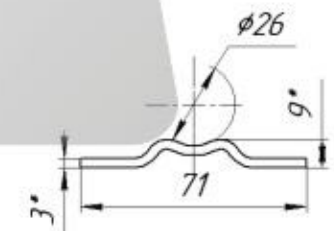
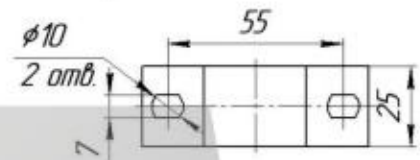
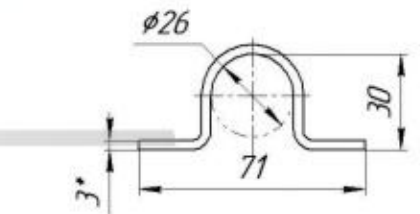





F32 Tube clamp kit d22 (Zn, SS)



Tube clamp (upper) – 6305430-03

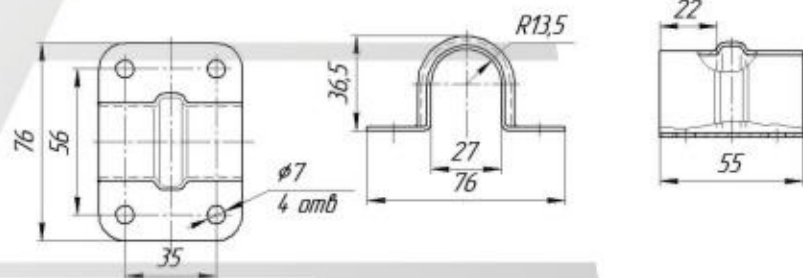

Tube clamp (lower) – 6305429-03

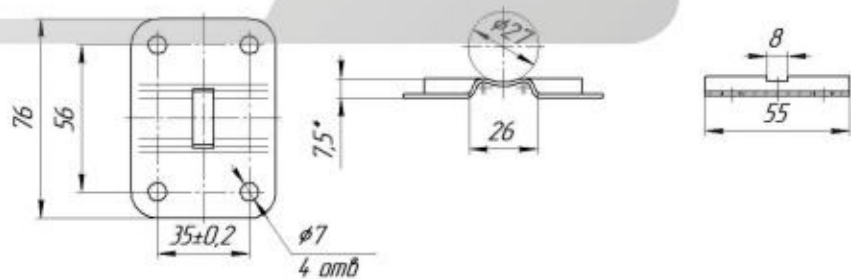

Bushing – 6305428-02

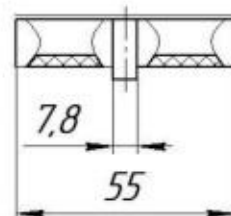



F33 Tube clamp kit d22 (Zn, SS)



Tube clamp (upper) – 6305430-02



Tube clamp (lower) – 6305429-02



Bushing – 6305428-02

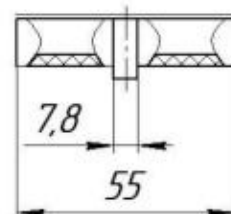
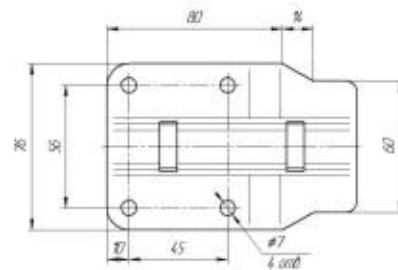
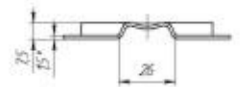
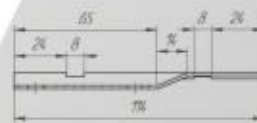
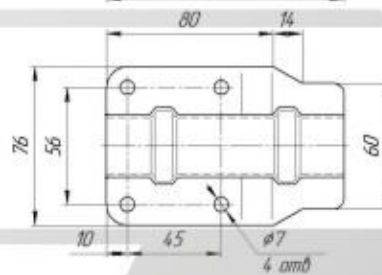
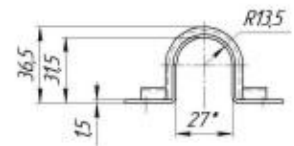
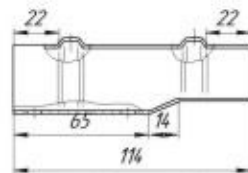





F34 Tube clamp kit d27 (Zn, SS)



Tube clamp (upper) – 6305430-04

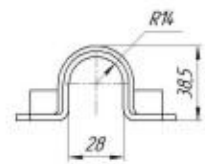
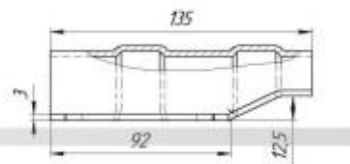

Tube clamp (lower) ГРКП753781.004

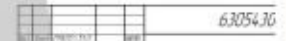
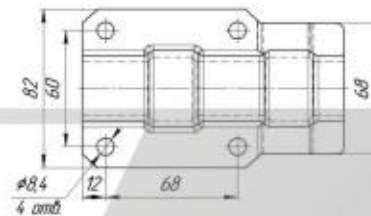

Bushing – 6305428-03

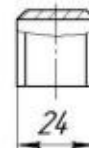
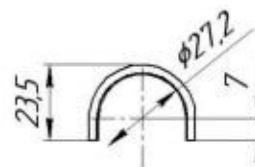
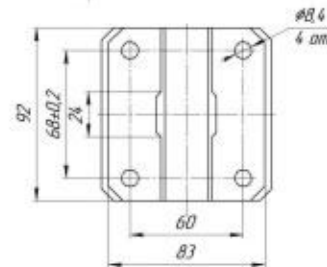
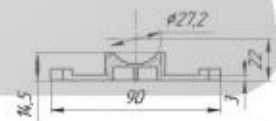



F35 Tube clamp kit d27 (Zn, SS)



Tube clamp (upper) – 6305430-05



Tube clamp (lower) ГРКП753781.004

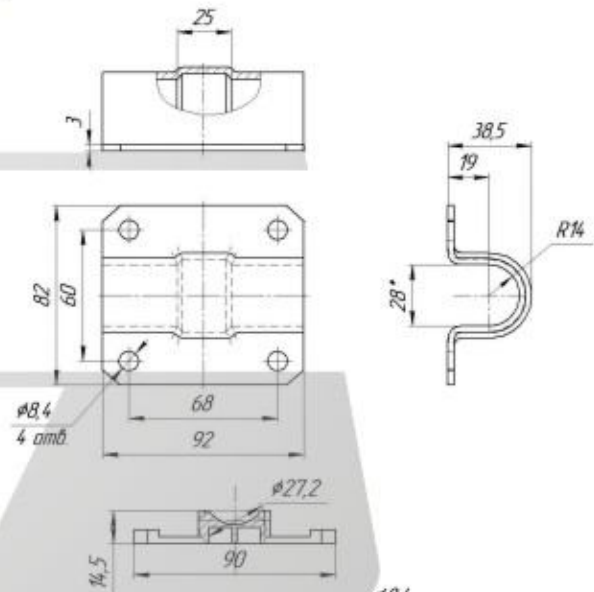

Bushing – 6305422-03

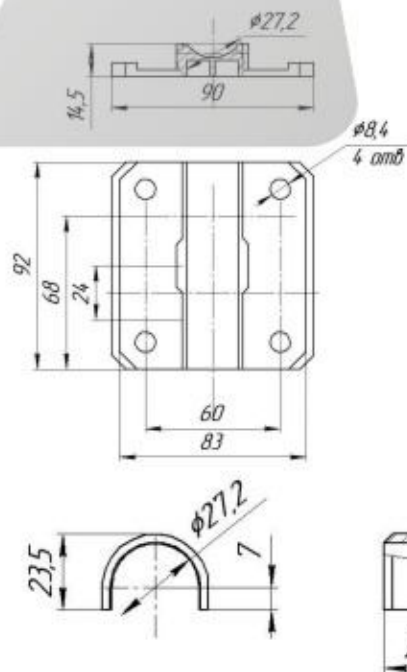



## F40 Cams and keepers

F41 Small Cam and keeper for lock d22 (Zn, SS)

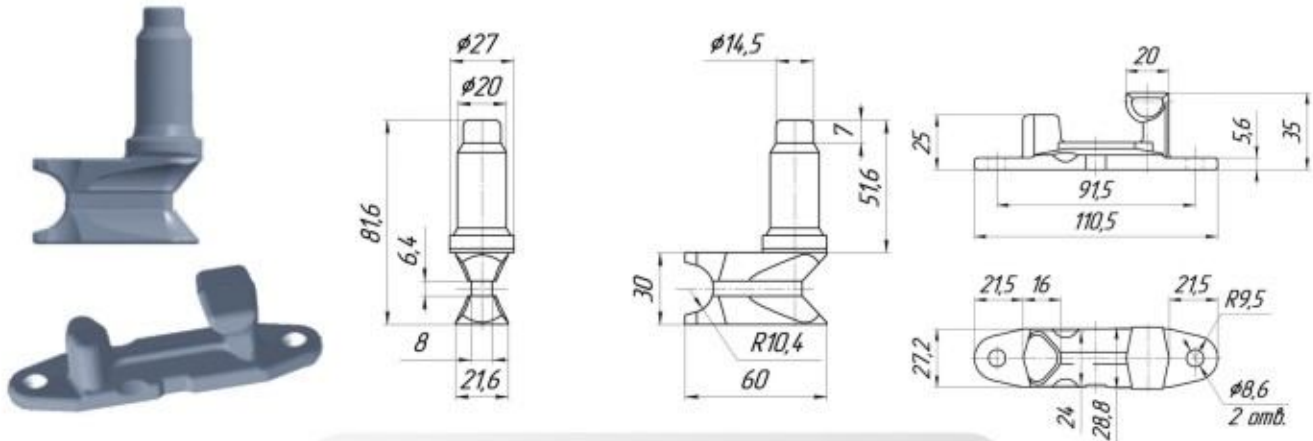

F42 Universal kit d22, d27 (Zn, SS)

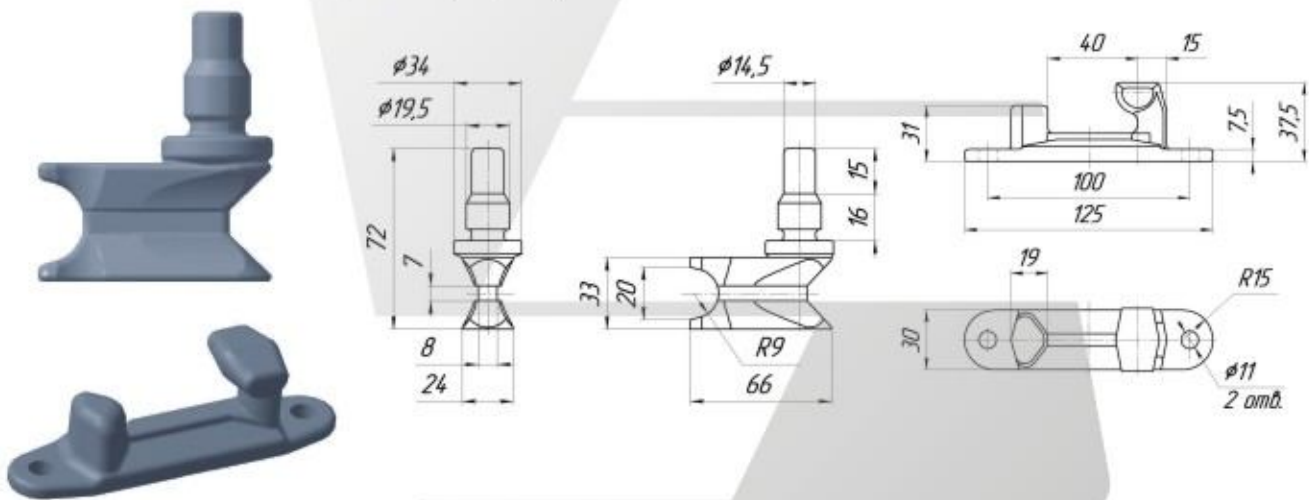

F43 Big cam and keeper for lock d27 (Zn, SS)

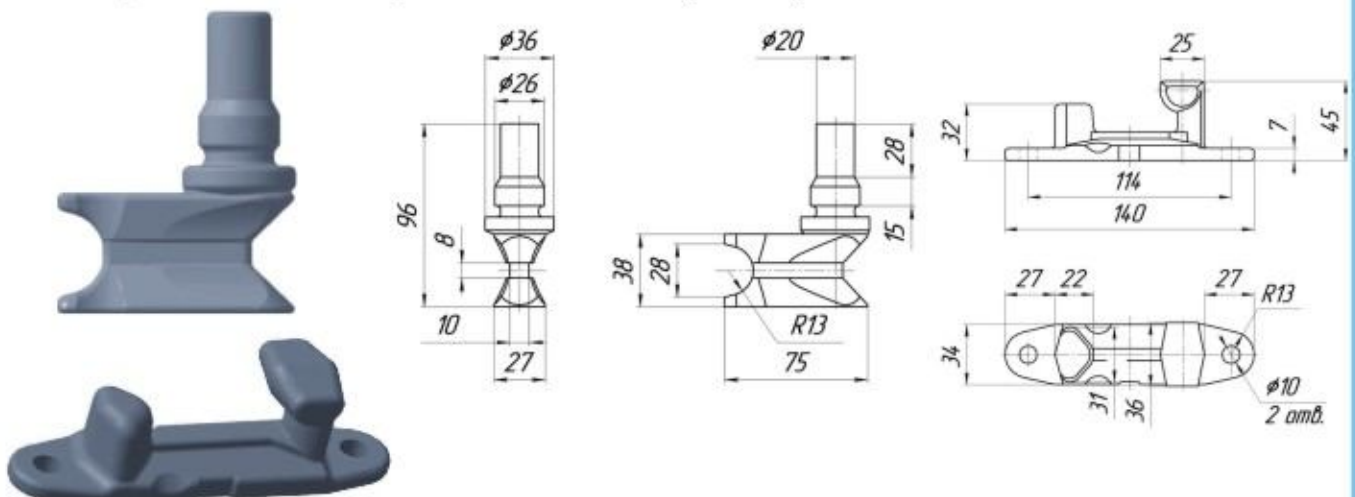





**A**

## Accessories

### A50 Door retainers

A51 T-shaped door retainer  
ГРКП456399.001ГЧ

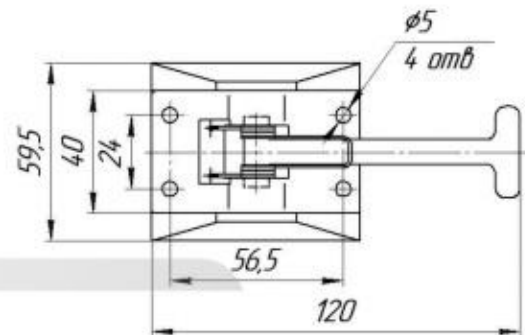
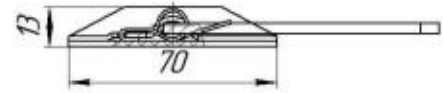

A52 Rear door retainer – ФД01.000

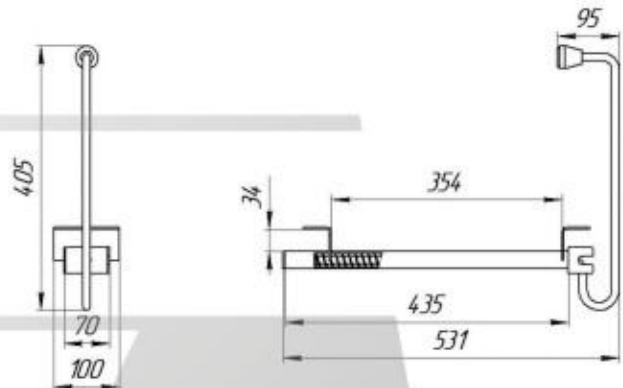
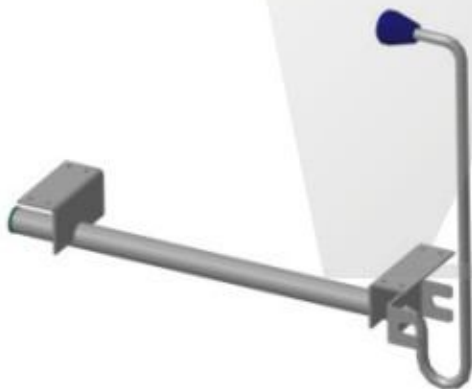

A53 Rear door retainer – ФД02.000

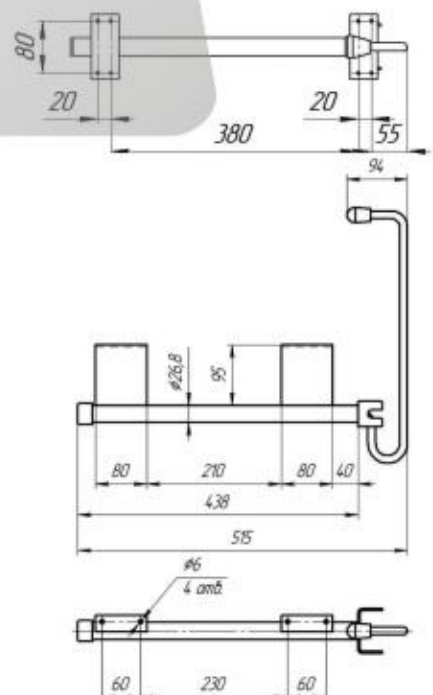
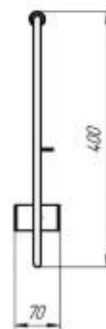
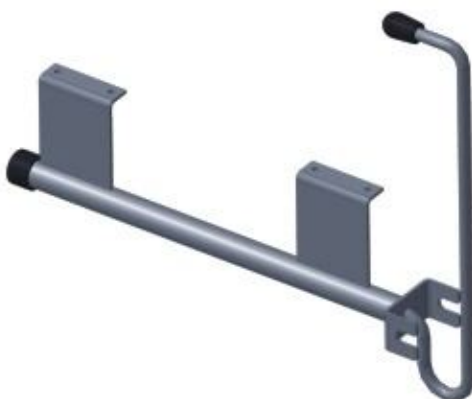



## A60 Clamps

A61 Mudguard's clamp – ГРКП301568



type	S1	S2
standart	2	2
	3	3
strengthened	5	4

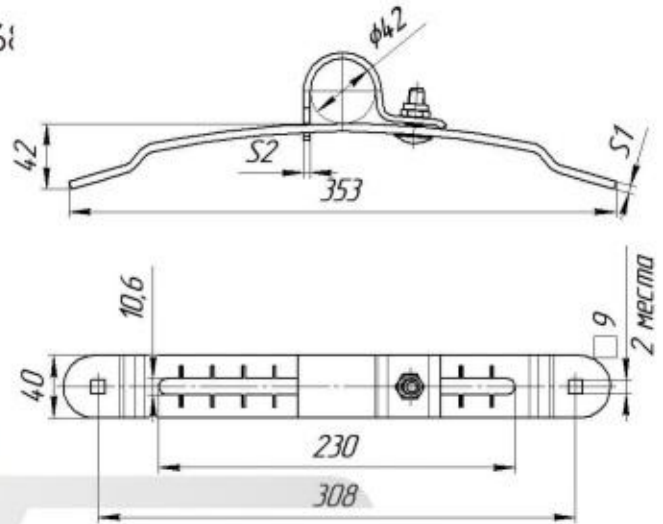

A62 Fastening bracket – ГРКП745312.005

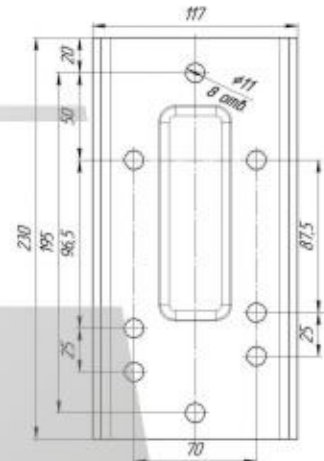
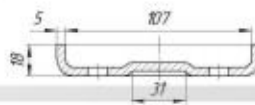

A63 Small fastening bracket – ГРКП745312.005

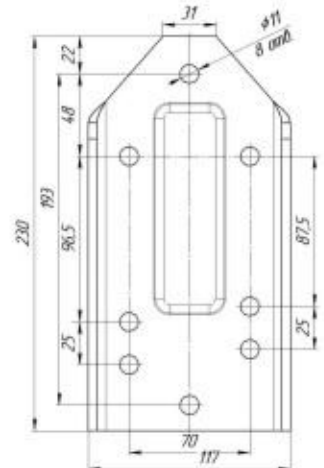



## A70 Protection bar

Convenient in service, fixed in several positions, can be easily lifted by one person

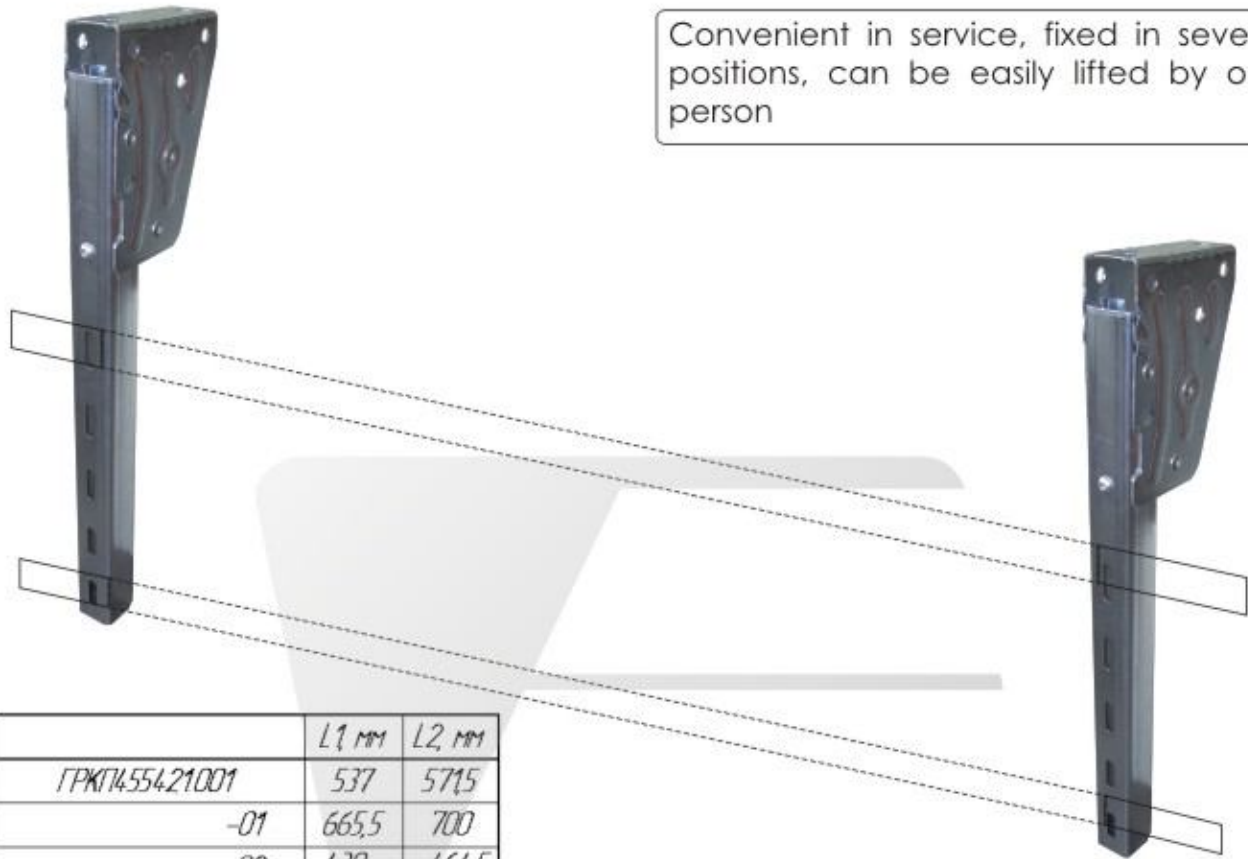

	L1, mm	L2, mm
ГРКП1455421001	537	5715
-01	665,5	700
-02	430	464,5
-03	2575	292
-04	3975	432
-05	4675	502
-06	8955	930







### A71 Protection bar – ГРКП455421.001

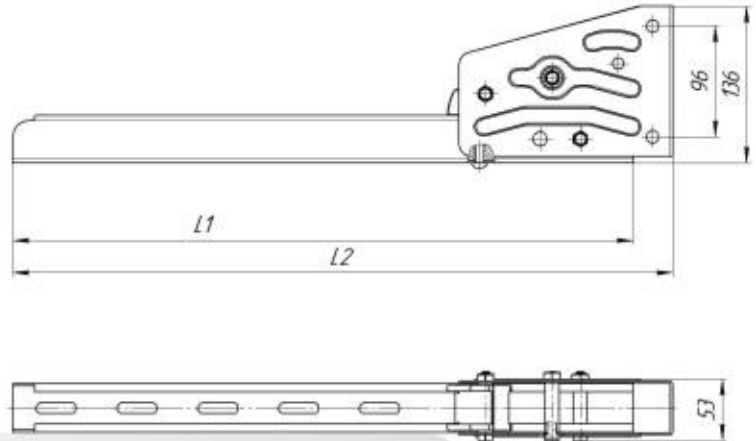

### A72 Protection bar with additional fixation

The kit includes a pin and a chain for additional fixation.

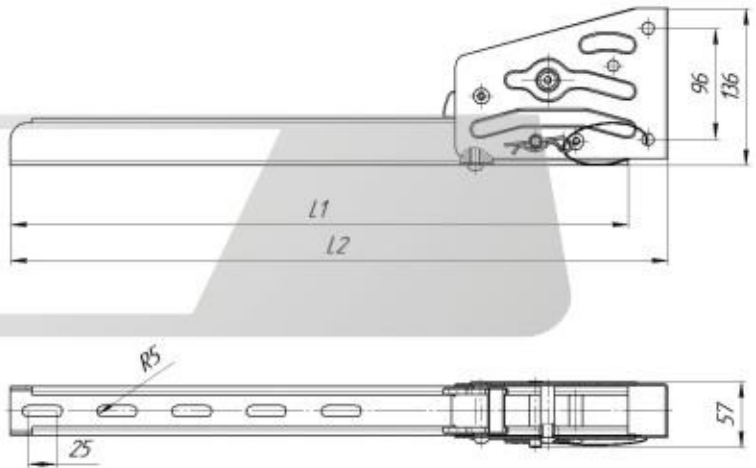



## A80 Ladders and steps

A81 Rear ladder with folding steps AC 00.00.000

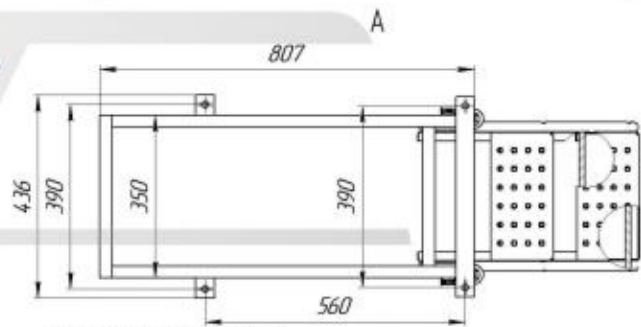
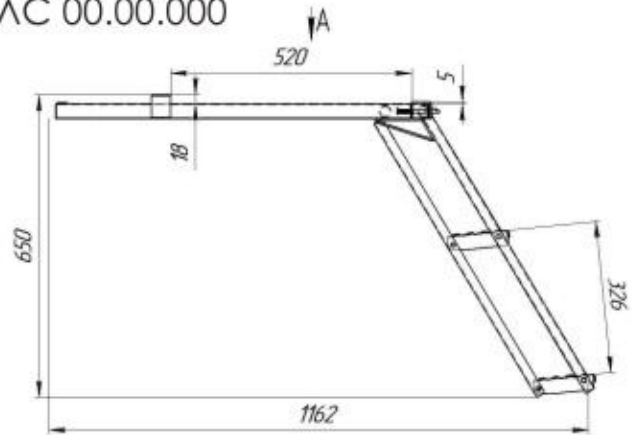

A82 Rear ladder with narrow steps AC 03.00.000

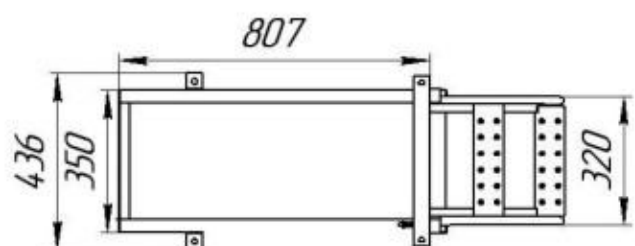
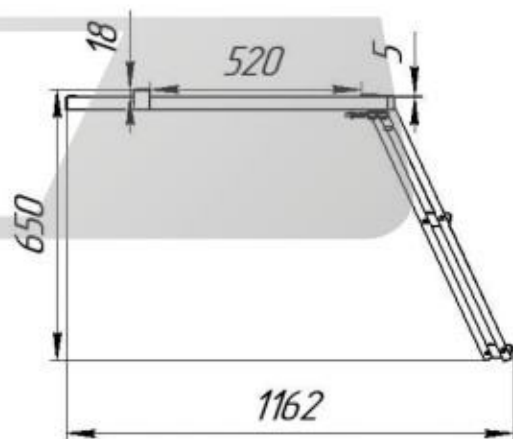



A83 Simple ladder AC 04.00.000

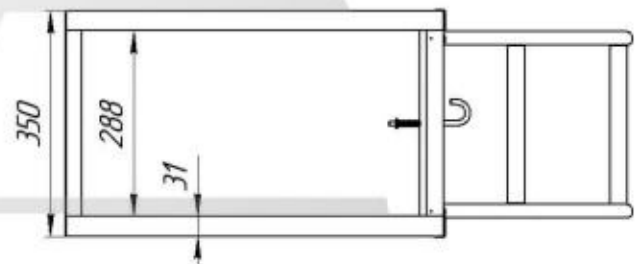
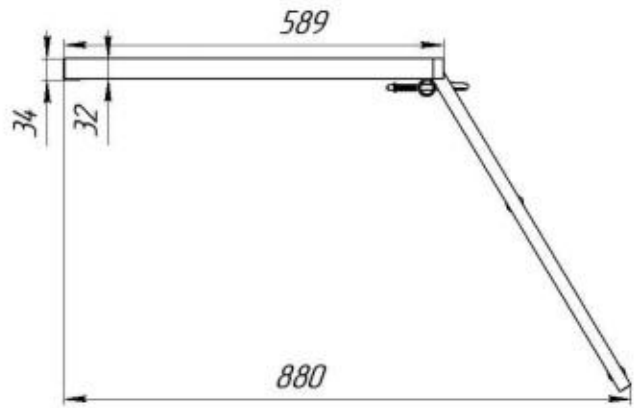

A84 Sliding 2 step rear ladder H=588 AC 02.00.000

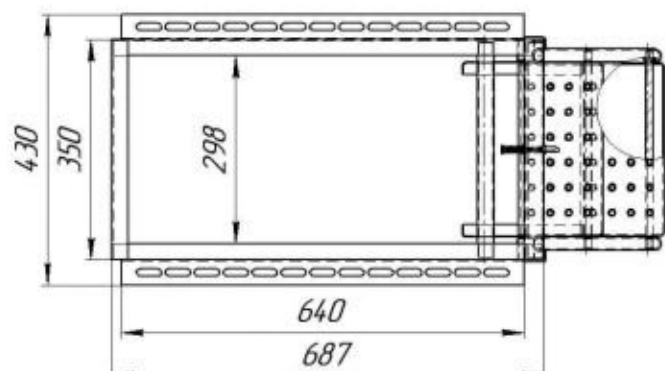
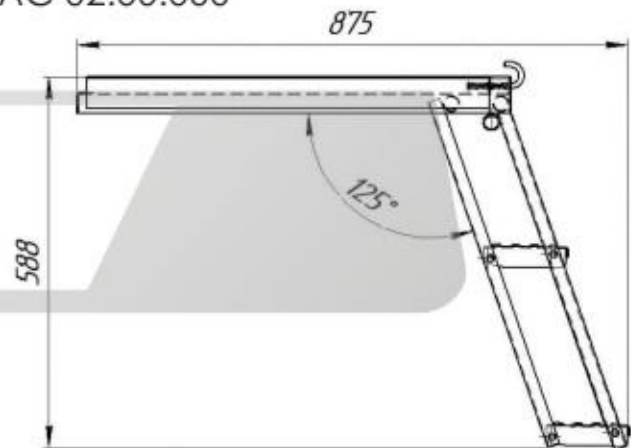





A85 Sliding 1 step rear ladder AC 01.00.000

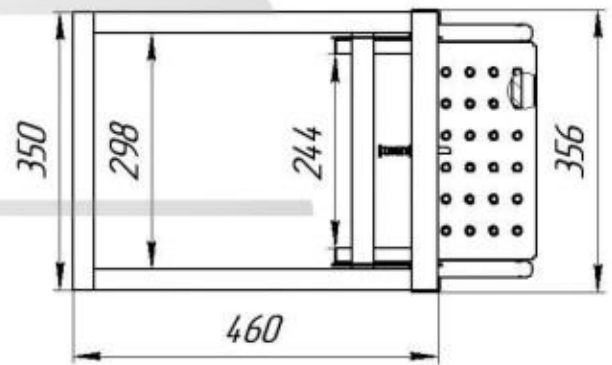
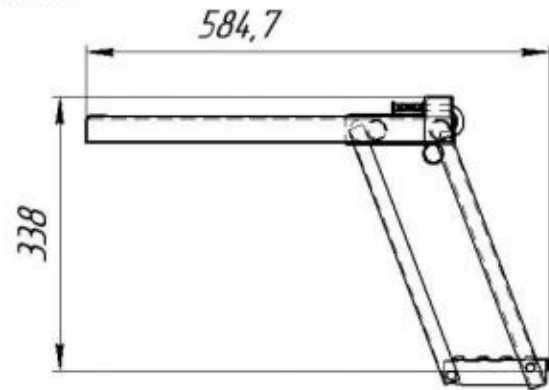

A86 Step AC 05.00.000

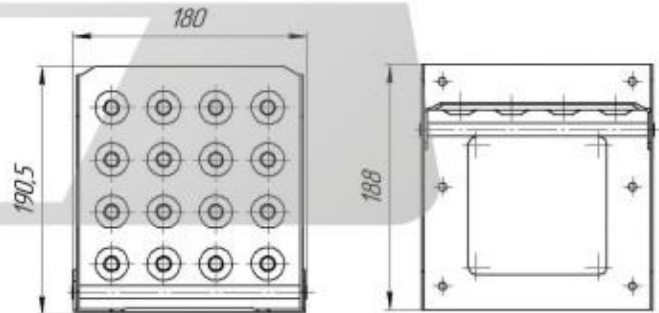

*Подножка в сложенном виде*

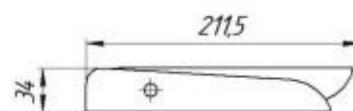



# L Rigging accessories

L91 Lashing rail

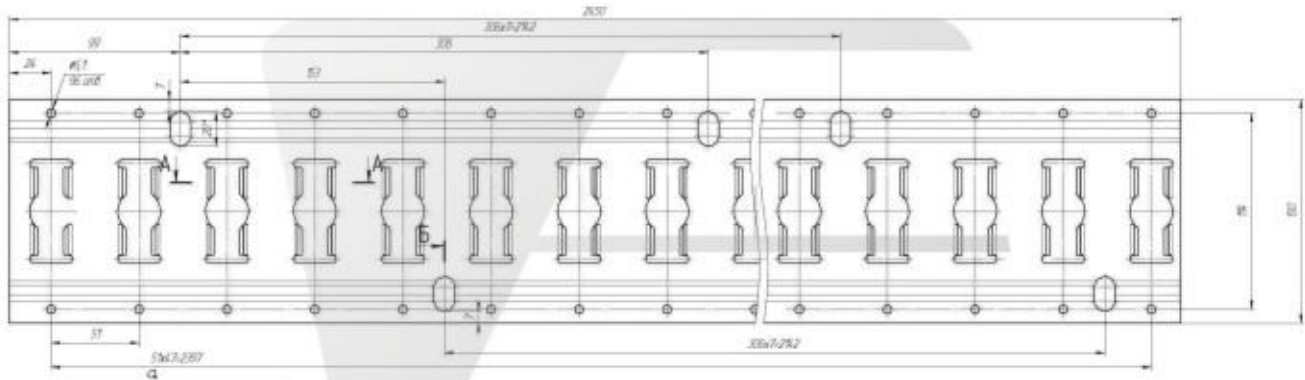

L92 Recessed swing

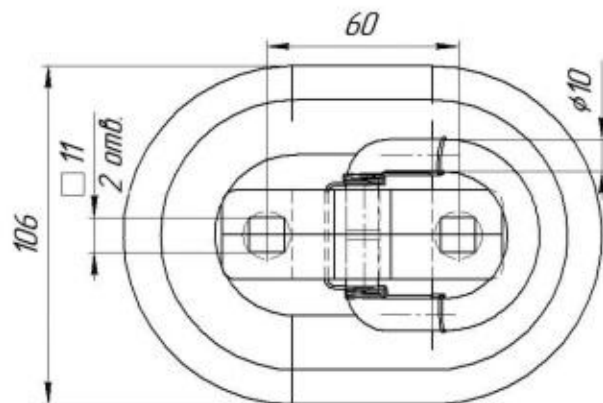



L93 Perforated sheet

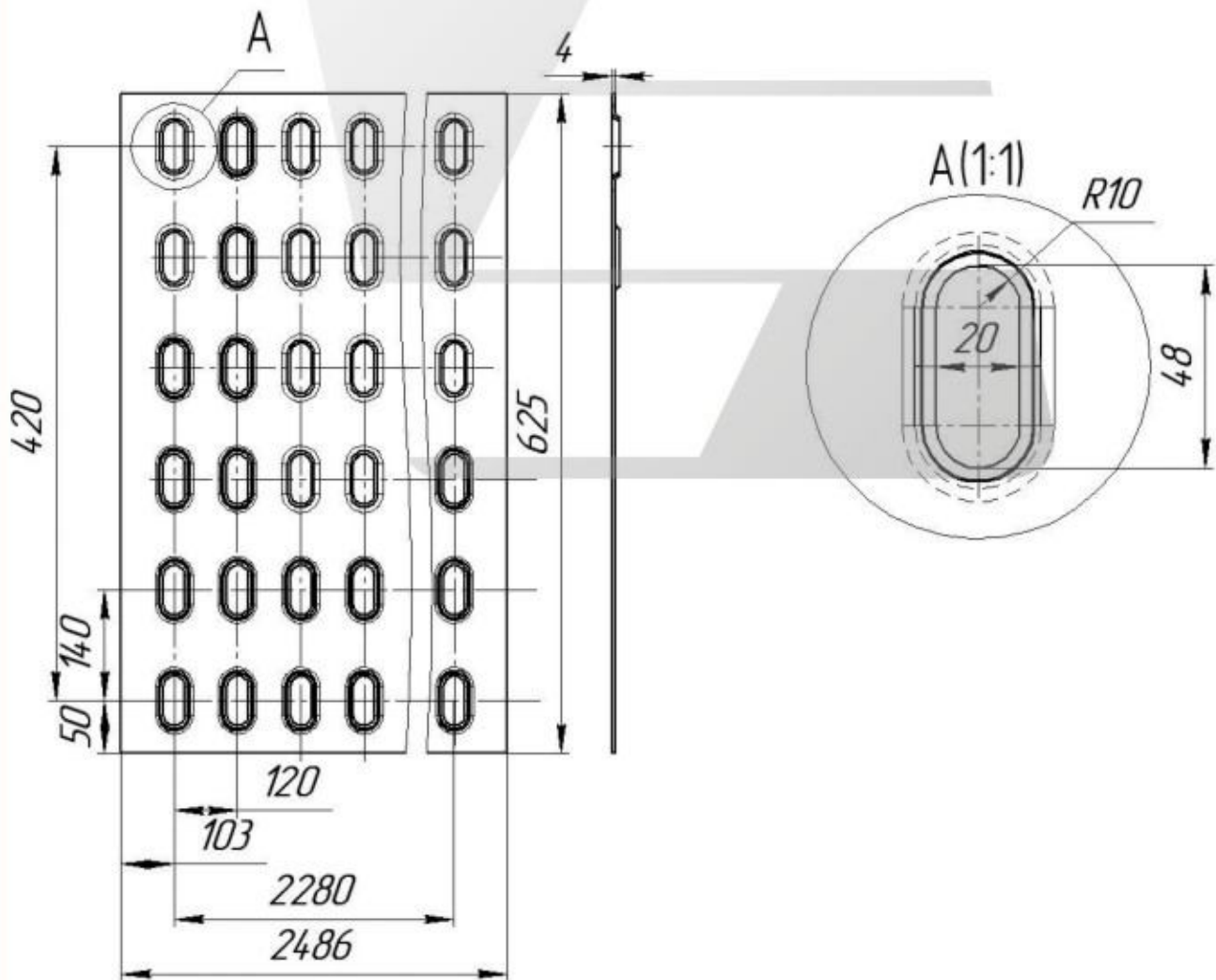





**P**

## Pillars

### P100 Folding dropside pillars

The purpose of dropside pillars is to fix the truck sides in closed position. They represent a strong and secure mechanism of fasteners with big levers and have a handy removable design.

### P101 Two-locked intermediate pillar

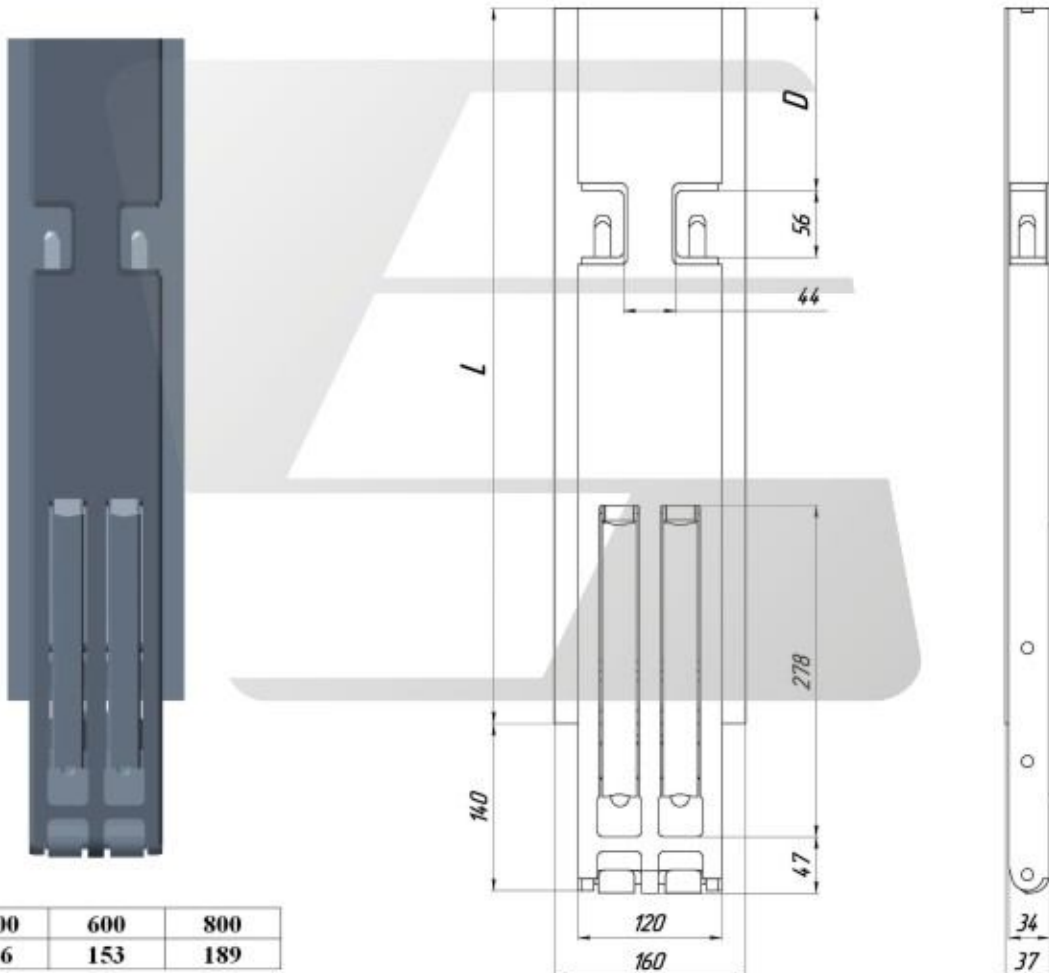

<b>L</b>	<b>400</b>	<b>600</b>	<b>800</b>
<b>D</b>	<b>16</b>	<b>153</b>	<b>189</b>



P102 One-locked front pillar (left/right)

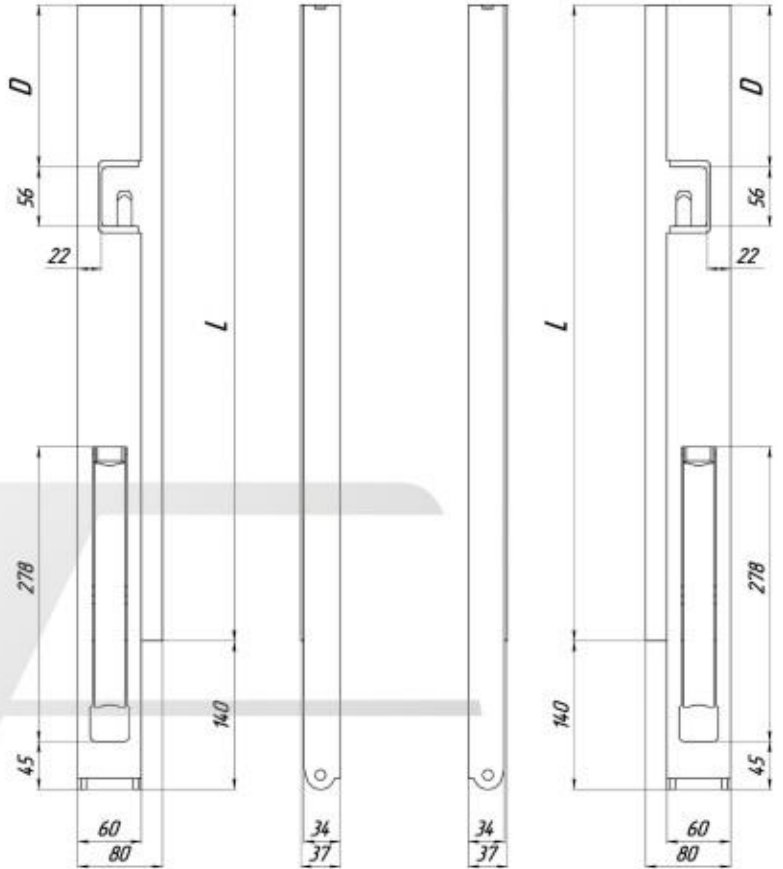
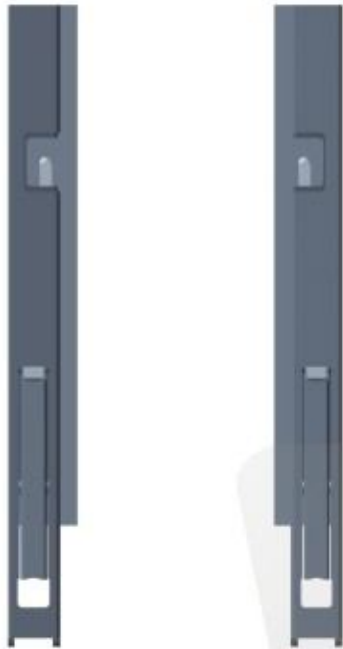

<b>L</b>	<b>400</b>	<b>600</b>	<b>800</b>
<b>D</b>	<b>16</b>	<b>153</b>	<b>189</b>

P103 Two-locked rear pillar (left/right)

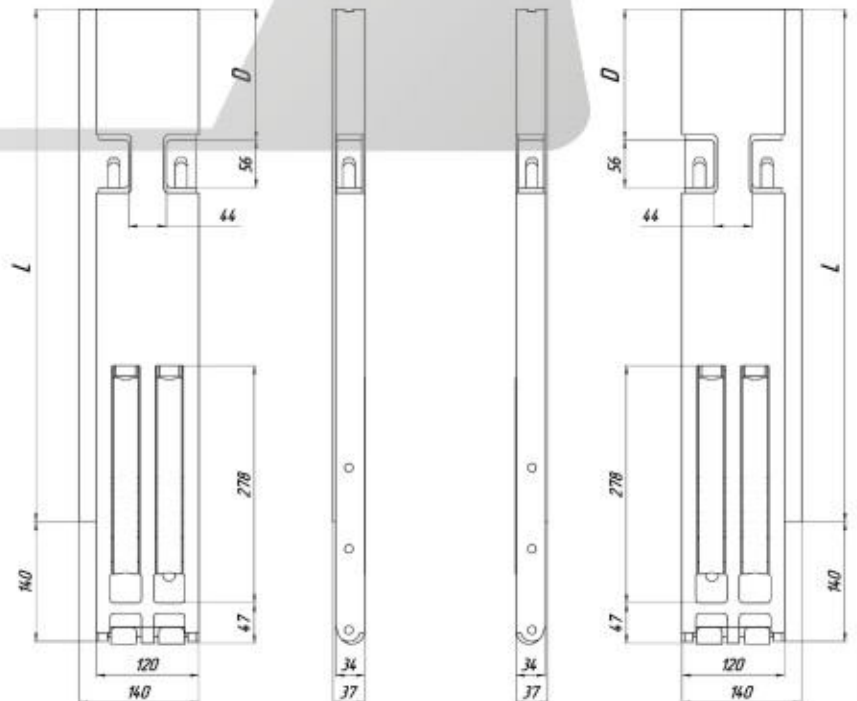
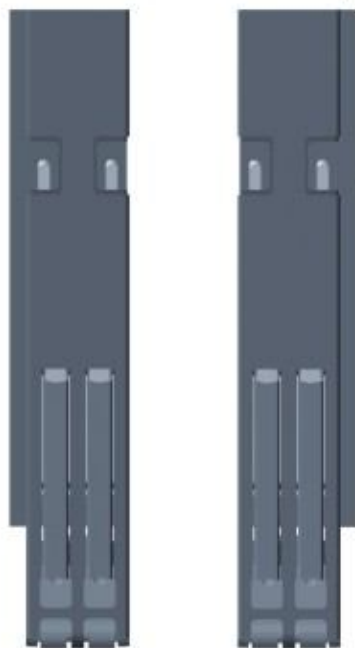

<b>L</b>	<b>400</b>	<b>600</b>	<b>800</b>
<b>D</b>	<b>16</b>	<b>153</b>	<b>189</b>



## P110 Folding dropside curtainside pillars

The pillars are designed for curtainside trailers and semitrailers. They have the rising part, which can be raised to the desired height.

P111 Folding curtainside pillar series 400

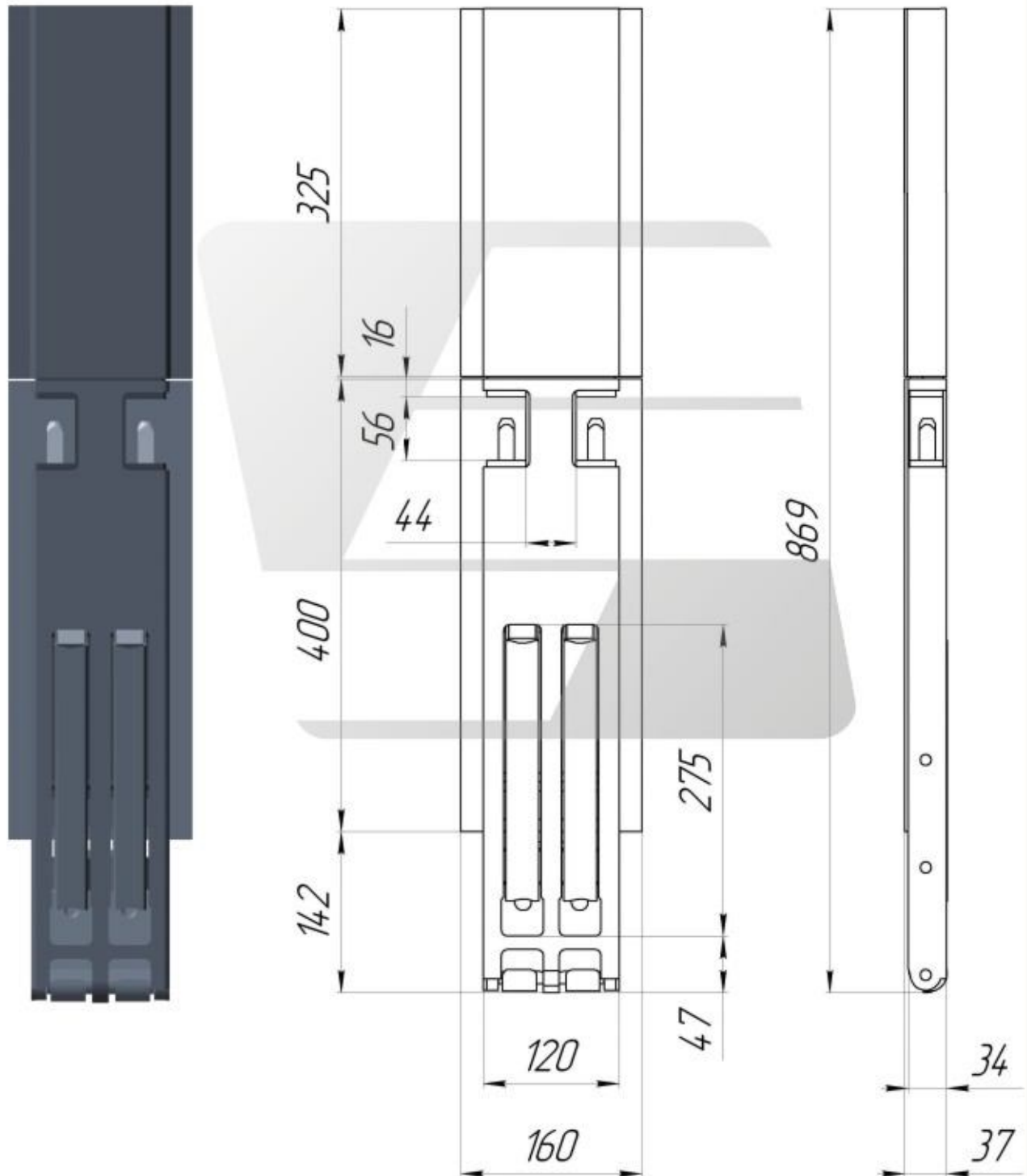





P112 Folding curtainside pillar series 600

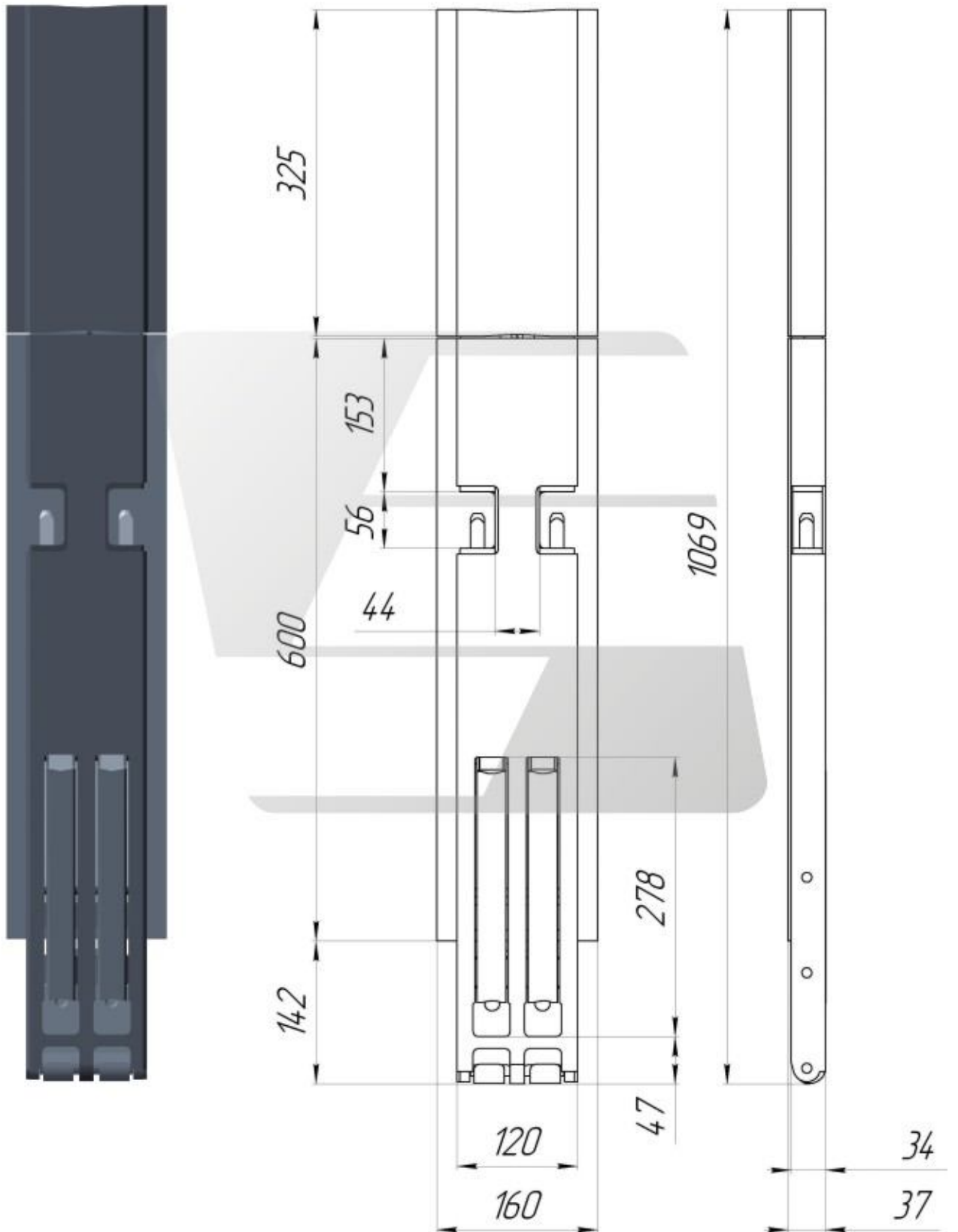



P113 Folding curtainside pillar series 600 with elongated channel and pockets

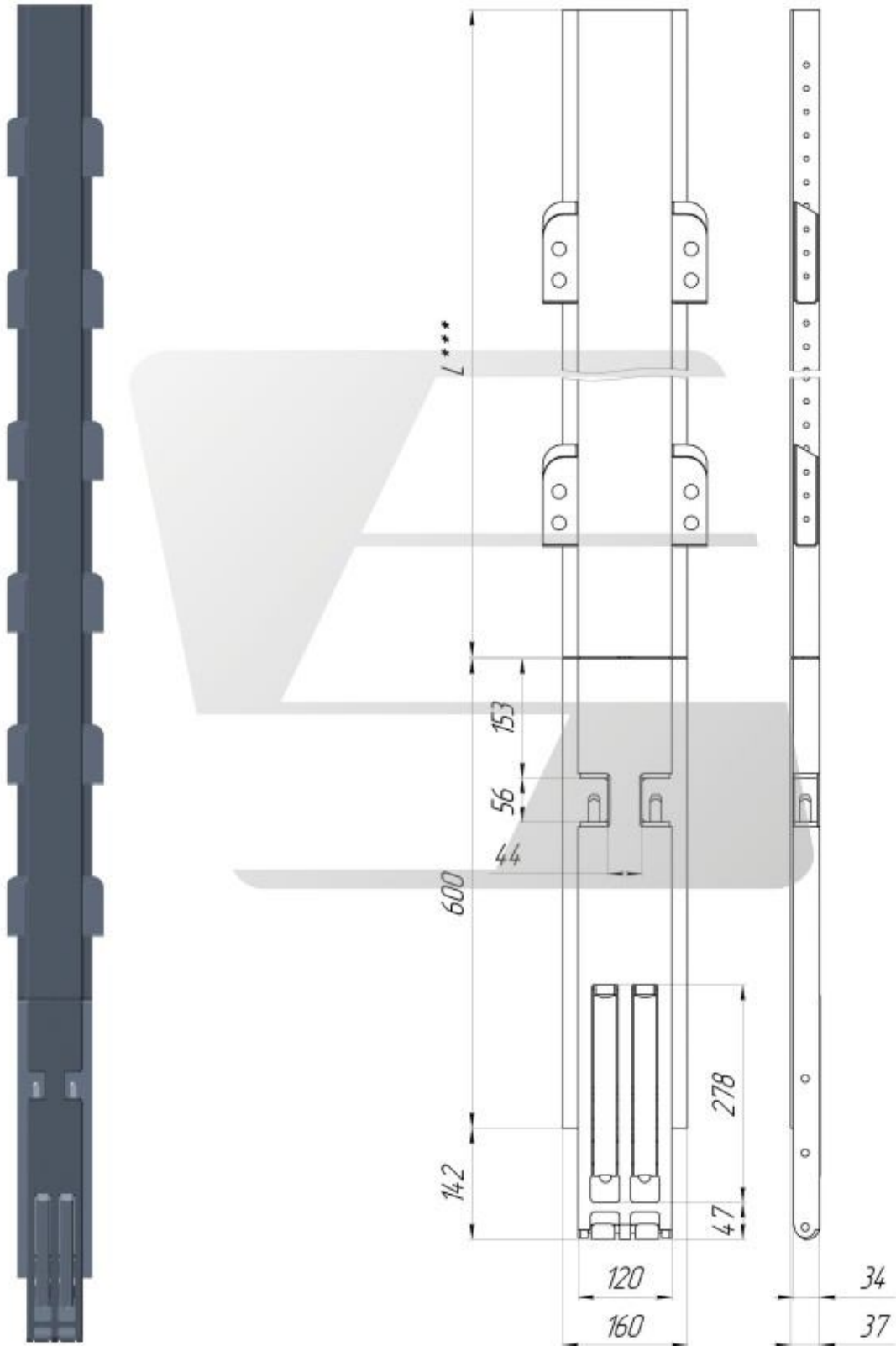



## P120 Intermediate dropside pillars

These are the folding pillars used in a set with dropside locks.

P121 Intermediate dropside pillar for aluminum boards 86 mm width



L (mm)	400	500	600	800
--------	-----	-----	-----	-----

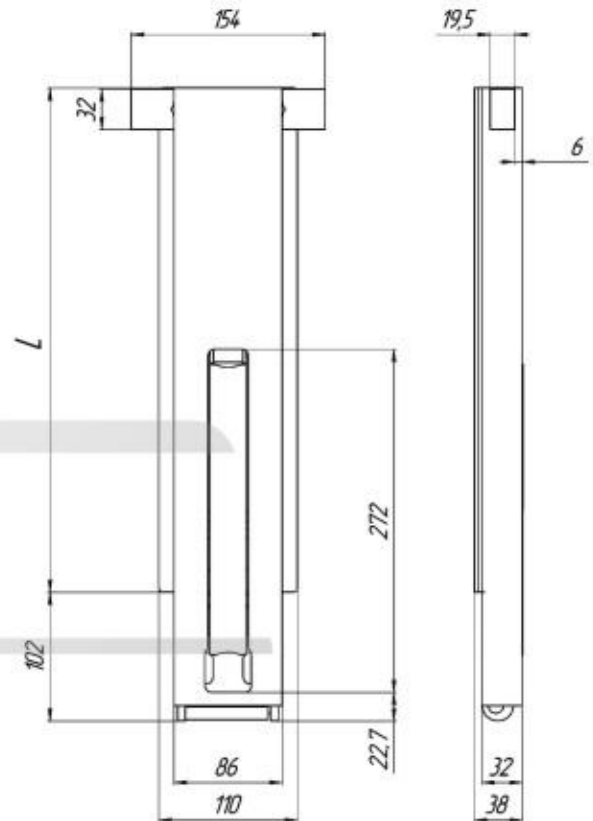

P122 Intermediate dropside pillar for aluminum boards 120 mm width



L (mm)	400	500	600	800
--------	-----	-----	-----	-----

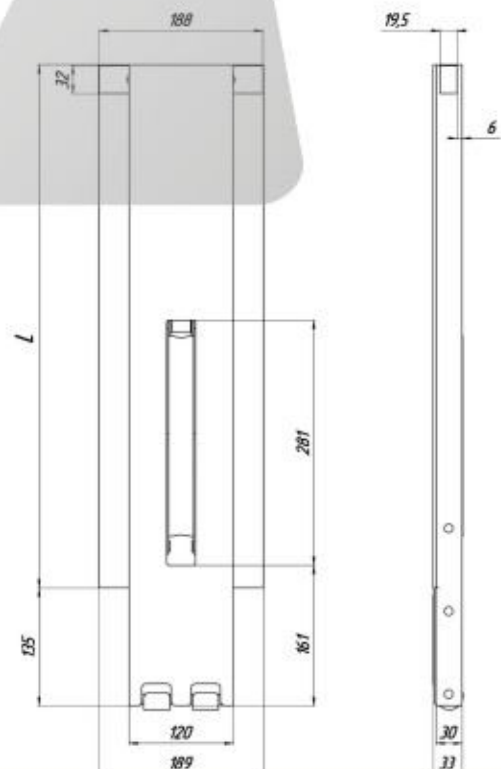





P123 Intermediate curtainside pillar for aluminum boards 86 mm width

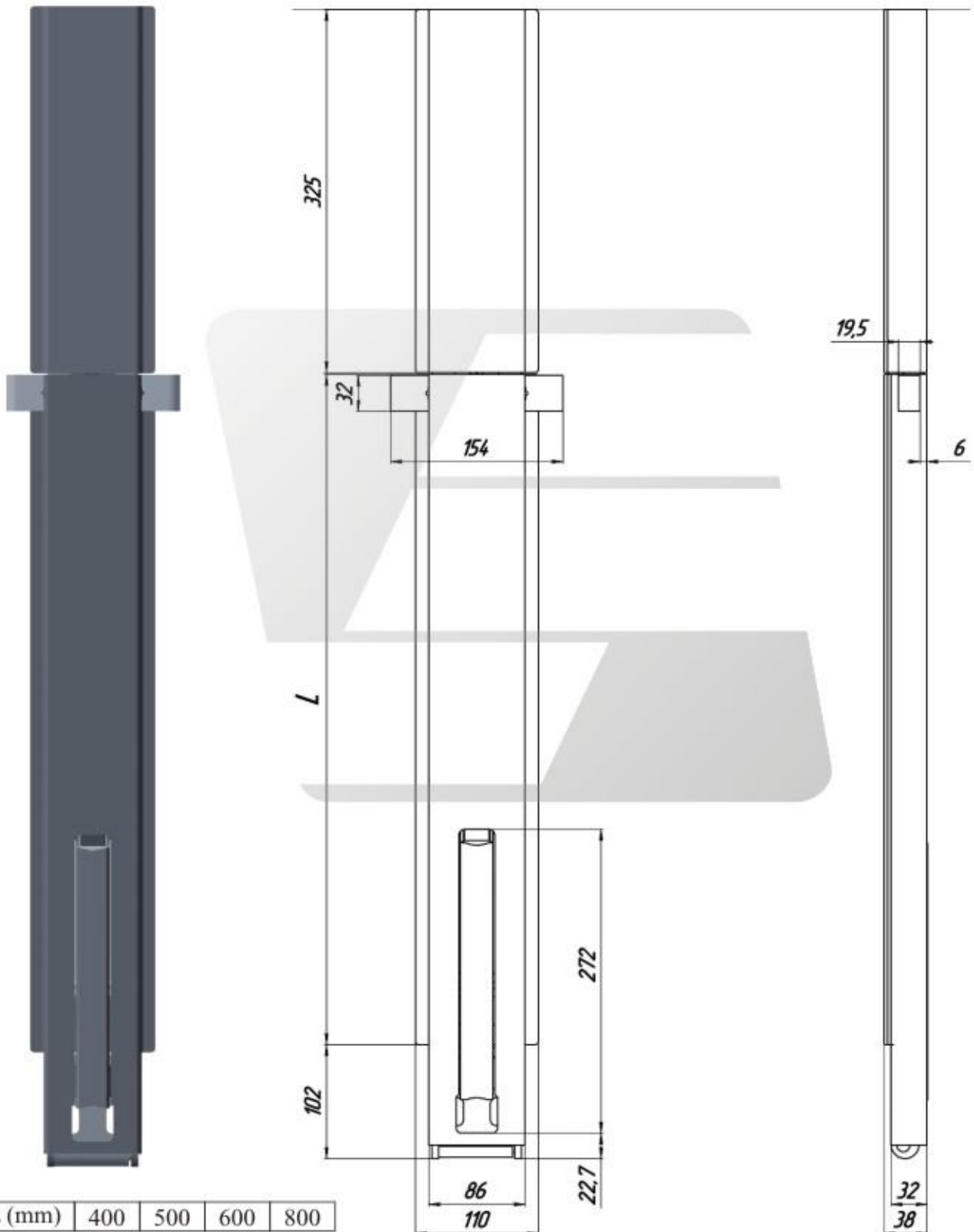



P124 Intermediate curtainside pillar for aluminum boards 120 mm width

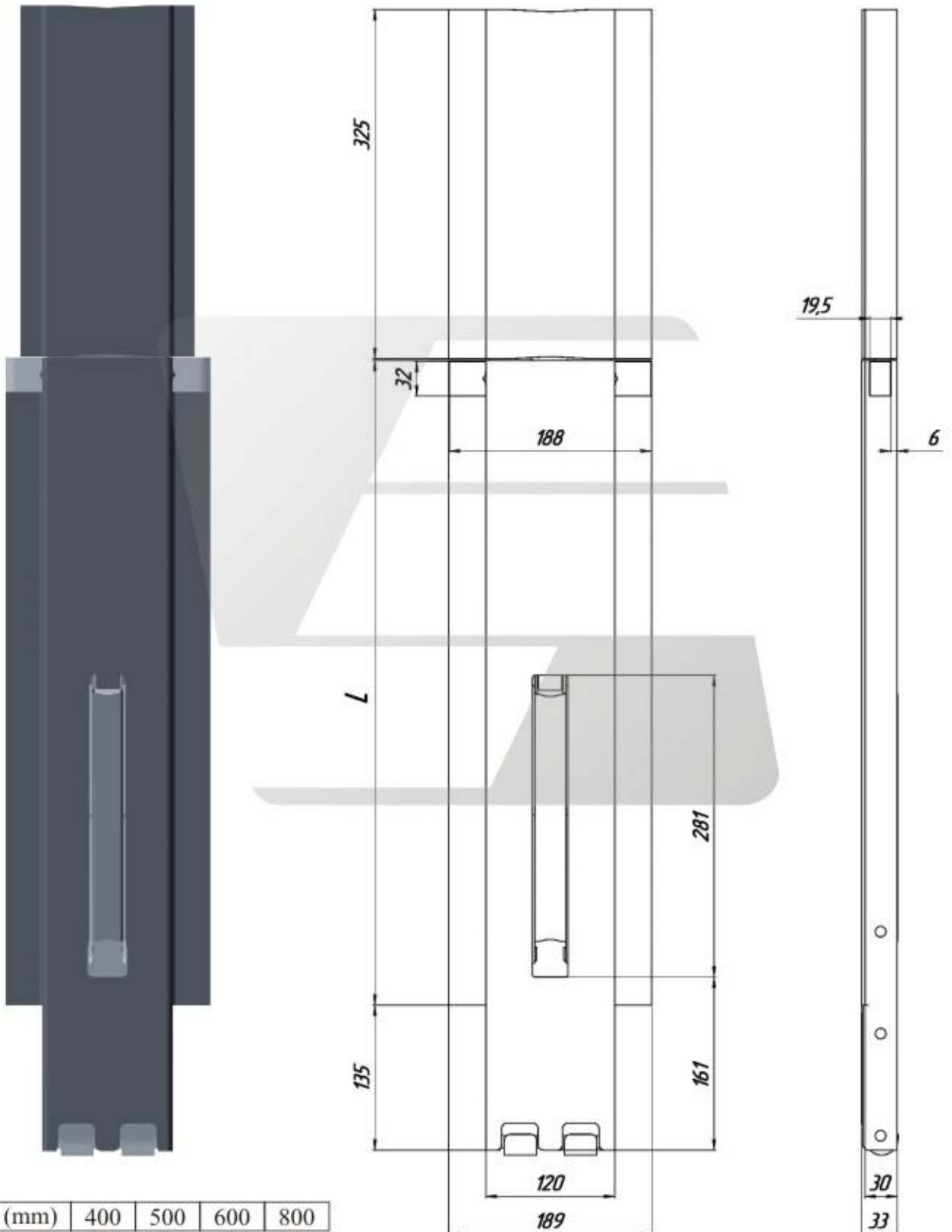

L (mm)	400	500	600	800
--------	-----	-----	-----	-----



P125 Intermediate curtainside pillar for aluminum boards 86 mm width with elongated channel and pockets

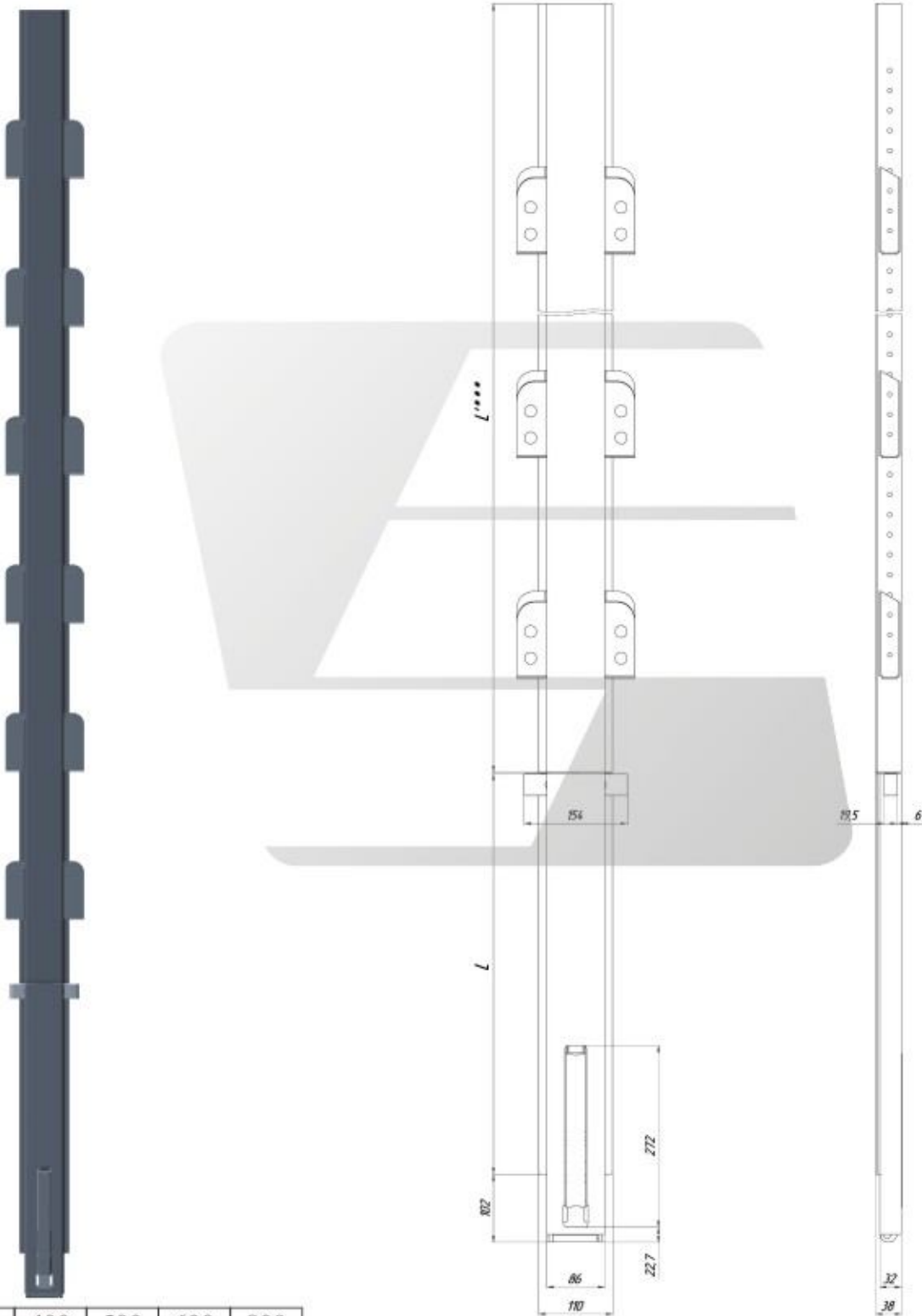

L (mm)	400	500	600	800
--------	-----	-----	-----	-----





P126 Intermediate curtainside pillar for aluminum boards 120 mm width with elongated channel and pockets

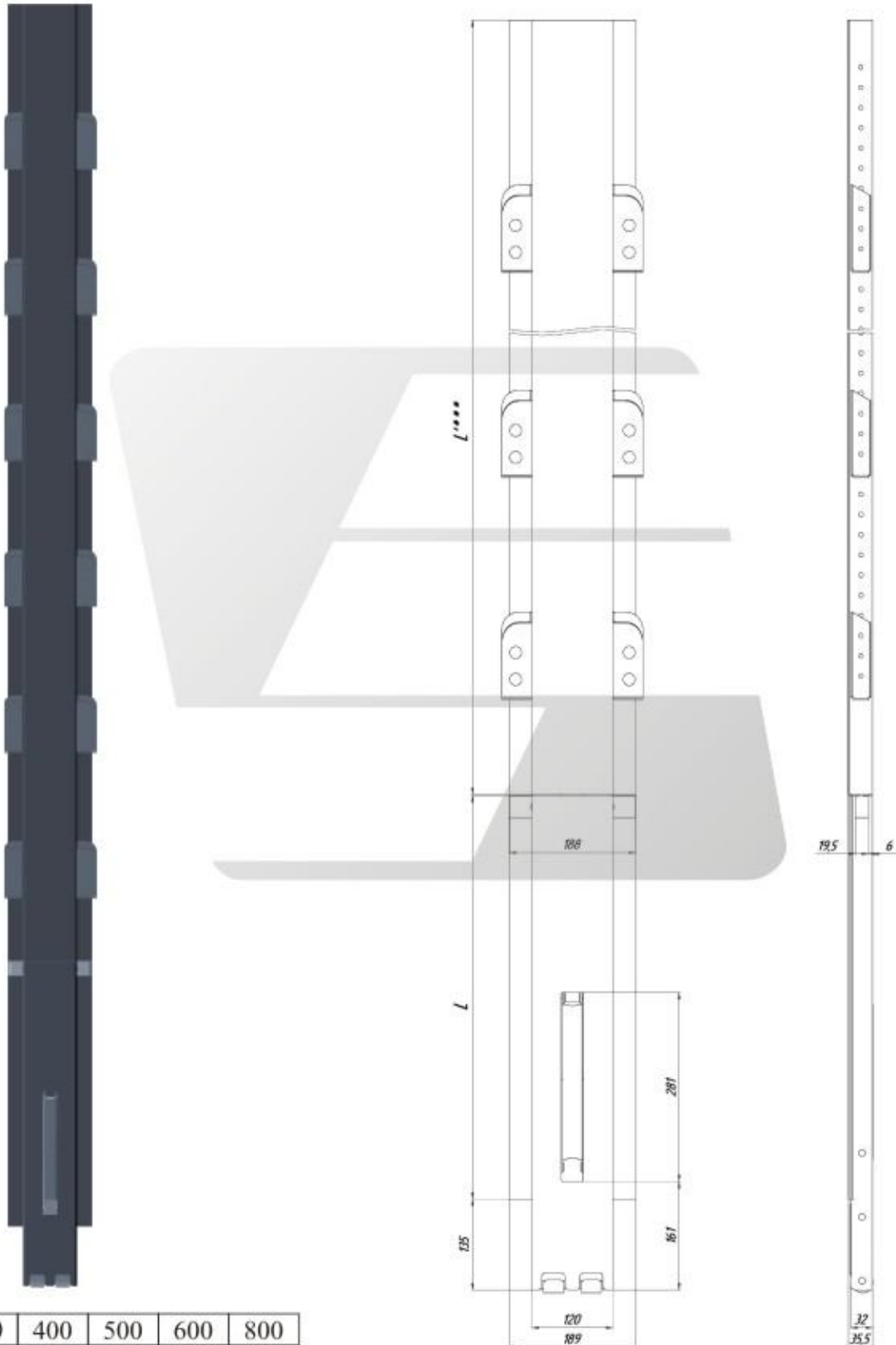



## P130 Intermediate curtainside pillars

Intermediate curtainside pillars are designed for curtainside semitrailers and can be easily moved aside. This provides the quickness of handling.

P131 Intermediate curtainside pillar for semitrailer with pockets and telescopic extender

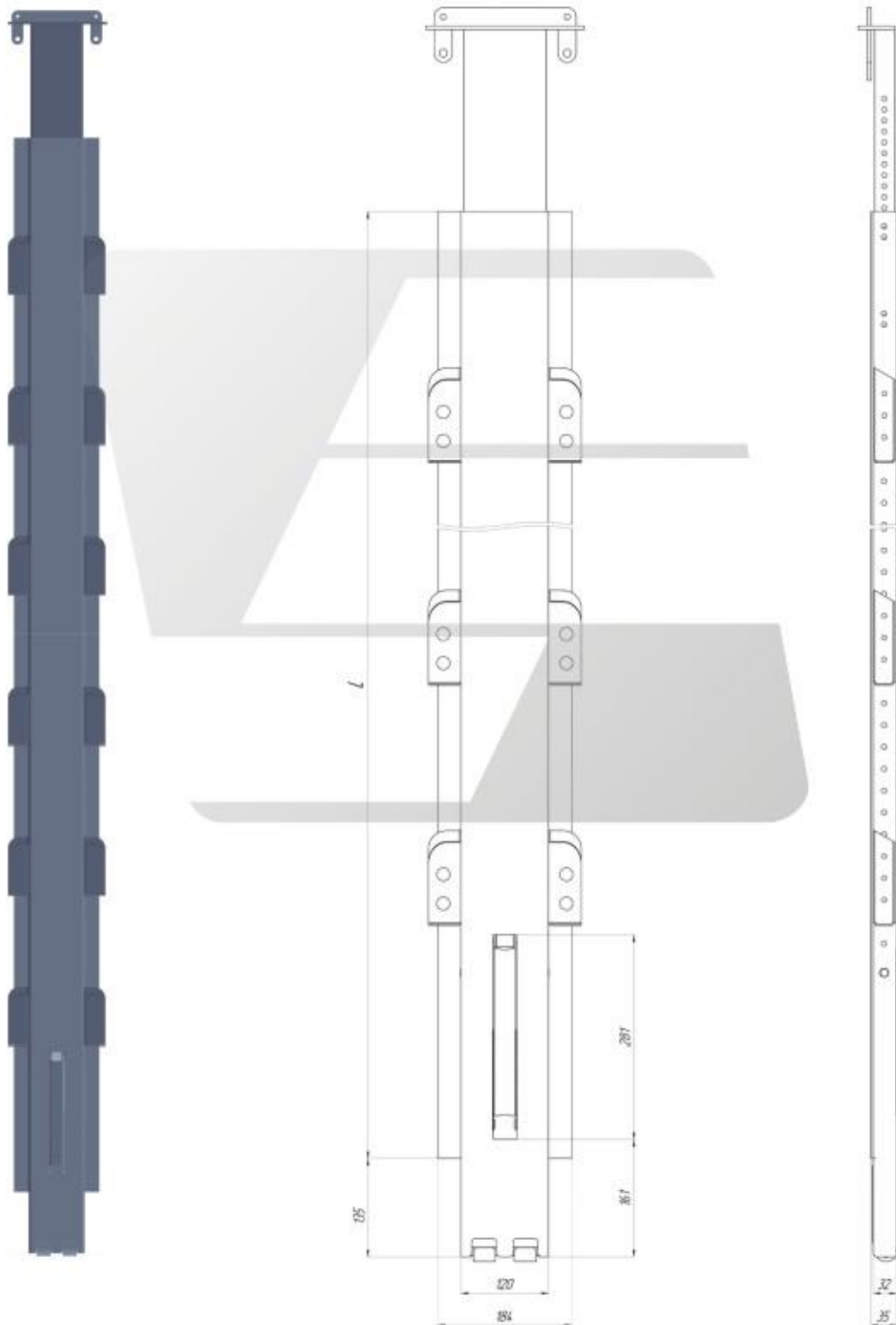



P132 Intermediate curtainside pillar for semitrailer with pockets and additional slots for swivel

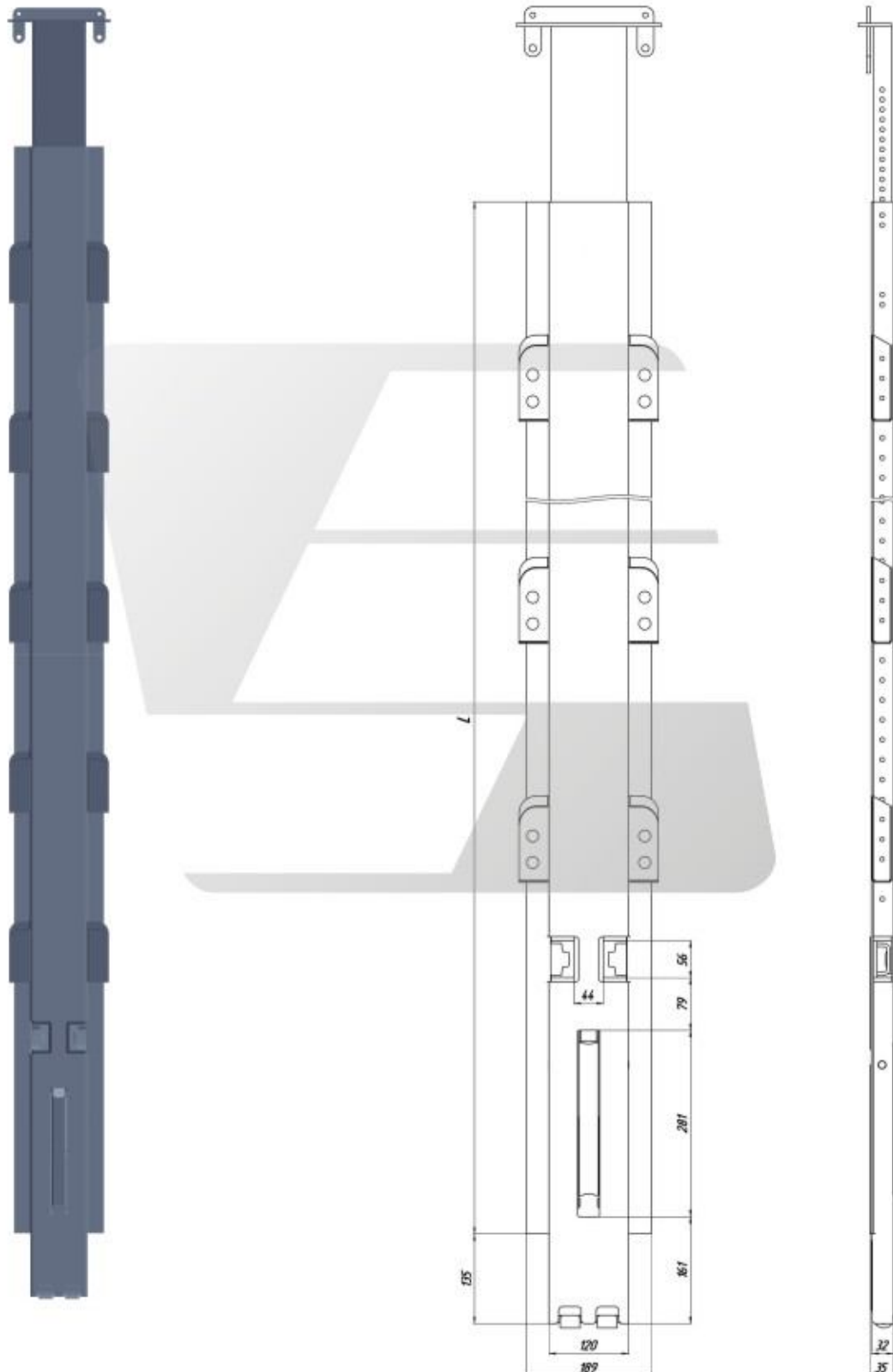





## P140 Dropside locks and spring bolts

P141 Aluminum non-plug lock (left/right)

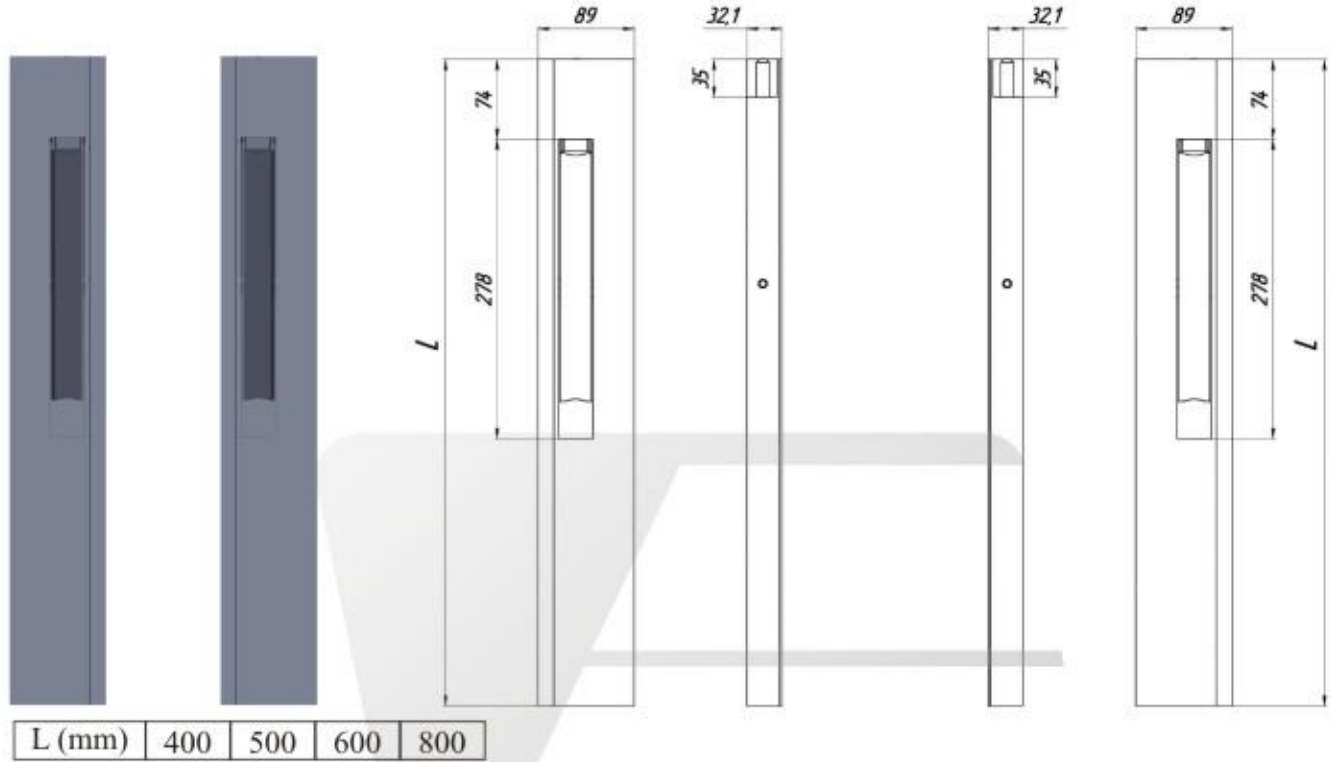

P142 Aluminum plug lock (left/right)

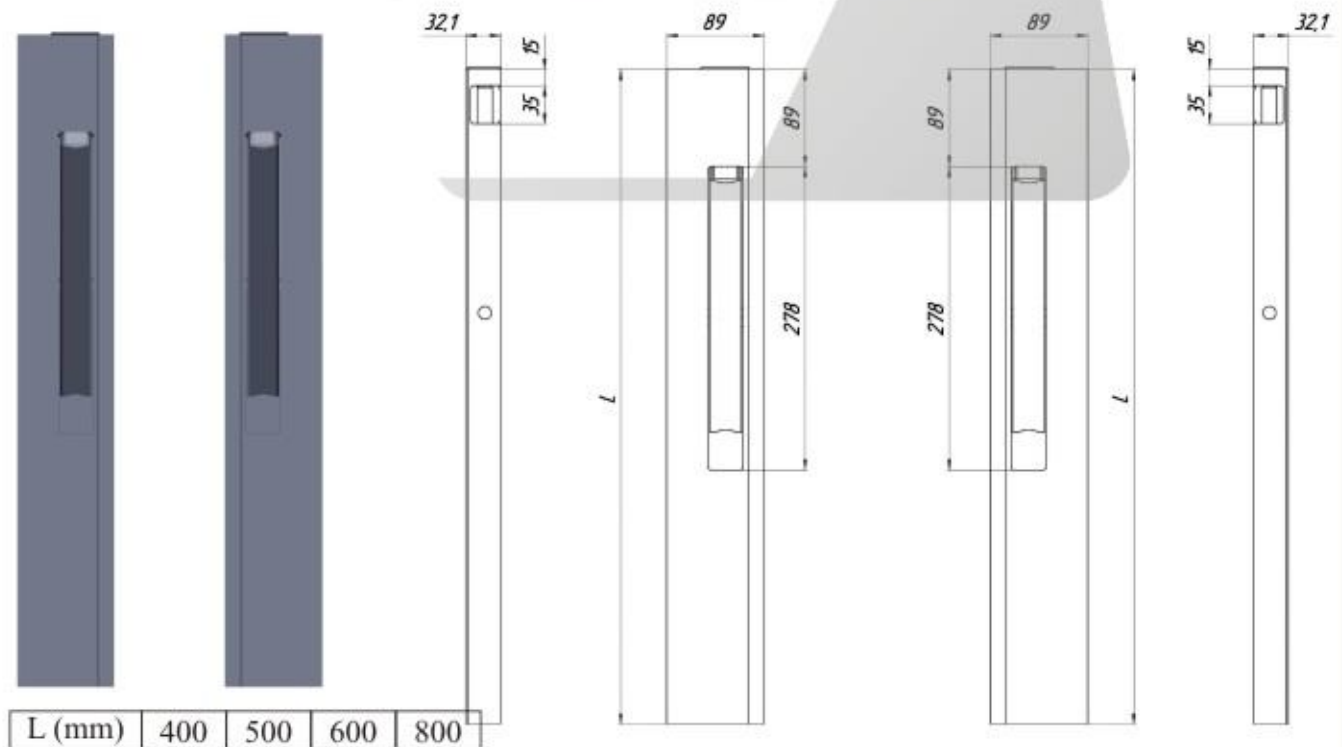



P143 Corner aluminum lock (left/right)

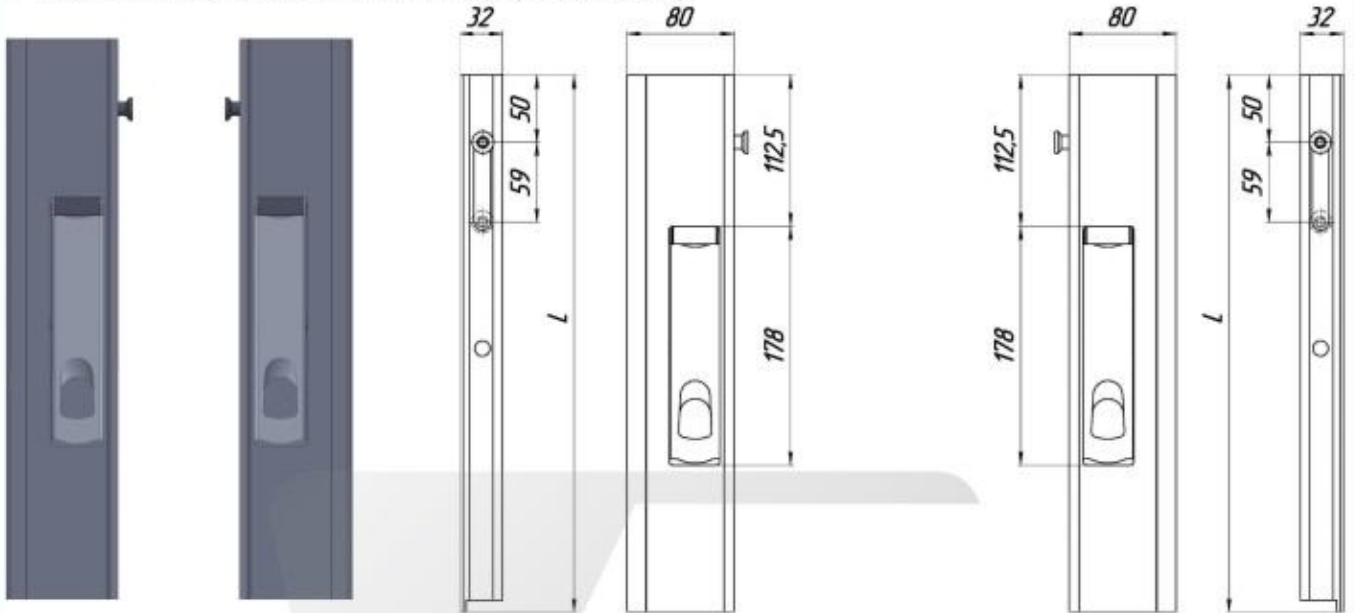

L (mm)	400	500	600	800
--------	-----	-----	-----	-----

P144 Sideboard hinges

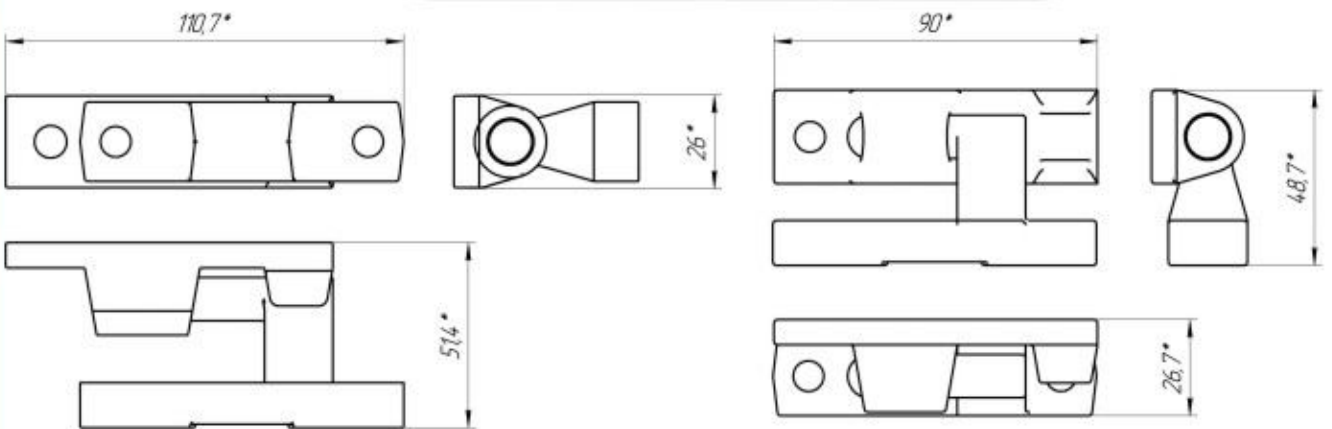



P145 Spring bolt

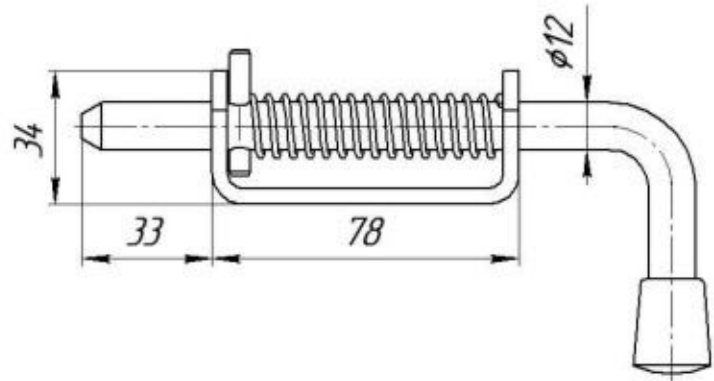

P146 Spring bolt

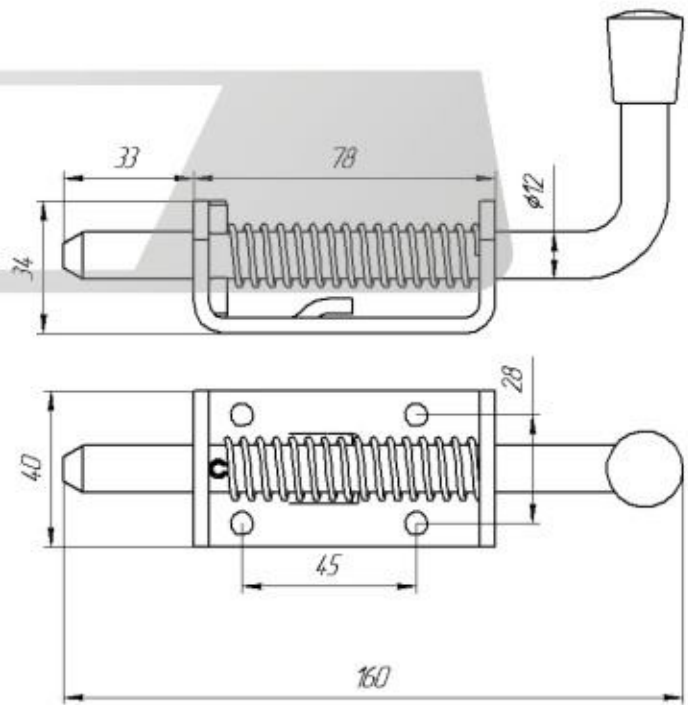





**ARAT SNEU KOMPLEKT**  
*Made in Russia*



### Turning and milling processing

The area is the most dynamically developing area of the company. Procurement of new items of equipment is performed every six months. At present the machine tool holding includes: universal milling machines with digital control made in Germany, Deckel Maho (five-axial), turning machining center made by OKUMA firm (Japan), model LB300 MW, with digital control OSP-U100L, horizontal, two pallet machining center with digital control (Fanuc 32i-A) Doosan ACE-HC400 and machining center MAZAK-NEXUS 4000II







Manufactured items are delivered to leading world companies



